

# Hospitality Contactless Check-in Solutions

*by e-Smart Mobile Key & Smart Code*



**SMART**  
**eLOCK**

## Seamless Unlock Innovation

Contactless check-in solutions with IoT & wireless online technology

### Professionality

Smartelock's development team has developers with more than 20 years of relevant experience, and we strive to provide the best service by developing various needs and convenience of the end-users on a daily basis. Besides, we have our own overseas sales force to respond to customers' needs in real-time.

### Advanced Technology

Applying World's first 13.56MHz RFID card, Mobile Access, and wireless online locker lock system development know-how to the hotel lock system, we provide more secure, stable, and qualified real-time lock control and monitoring hotel lock system.

### Competitive Price

We offer a competitive price and better or similar functions compared to other well-known and leading hotel door locks. Also our locks don't require any additional installation fee as they are wireless online locks and thus they don't need any wiring work, unlike other wired online locks.

### Customizing Service

We provide prompt customer service and solutions to the customer's any personal requests. As we own our R&D center, we proudly offer solutions straight away to the customer to review and apply.

### Full 3rd party integration

All our Smartelock hotel locks support 3rd party integration and compatible with them, such as PMS, GRMS, Room Intercom, and so on.

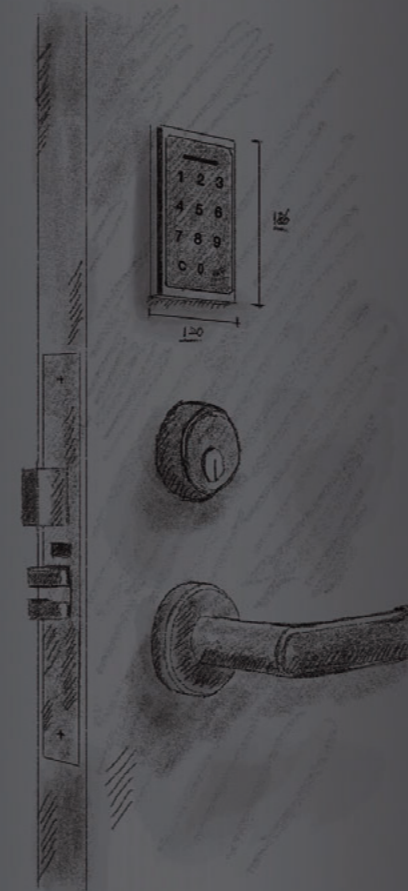

## Why SMARTeLOCK ?

01

- RFID/Mobile technology R&D capability
- Rich and long experienced engineers
- Real-time customizing

02

- Own R&D (S/W, H/W)
- Own factory and quality assurance
- On-time delivery

03

- Proven quality in global market
- Reliable reference
- Competitive price

# Seamless Unlock Innovation

Hospitality Contactless check-in solutions with IoT & wireless online technology

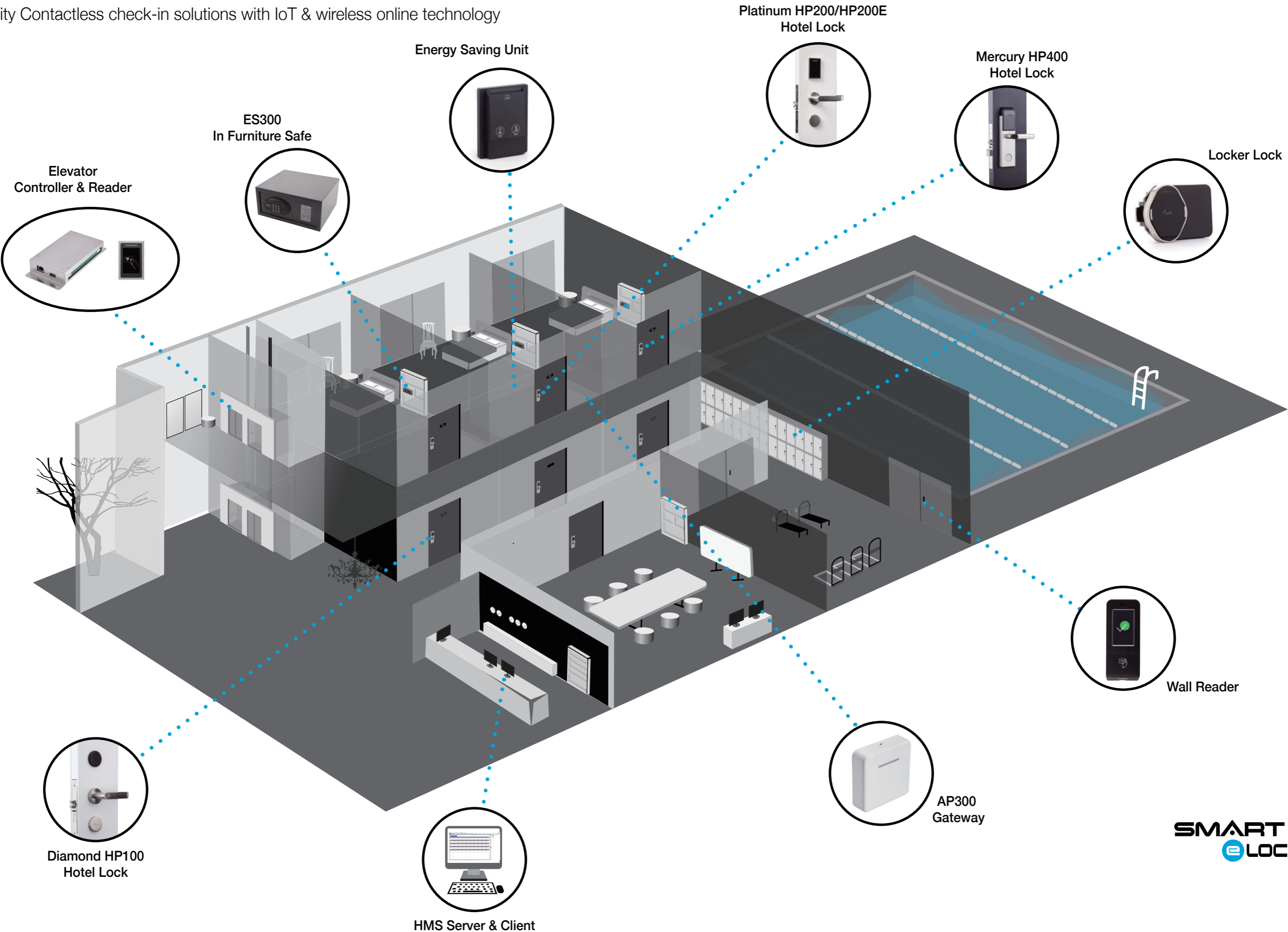

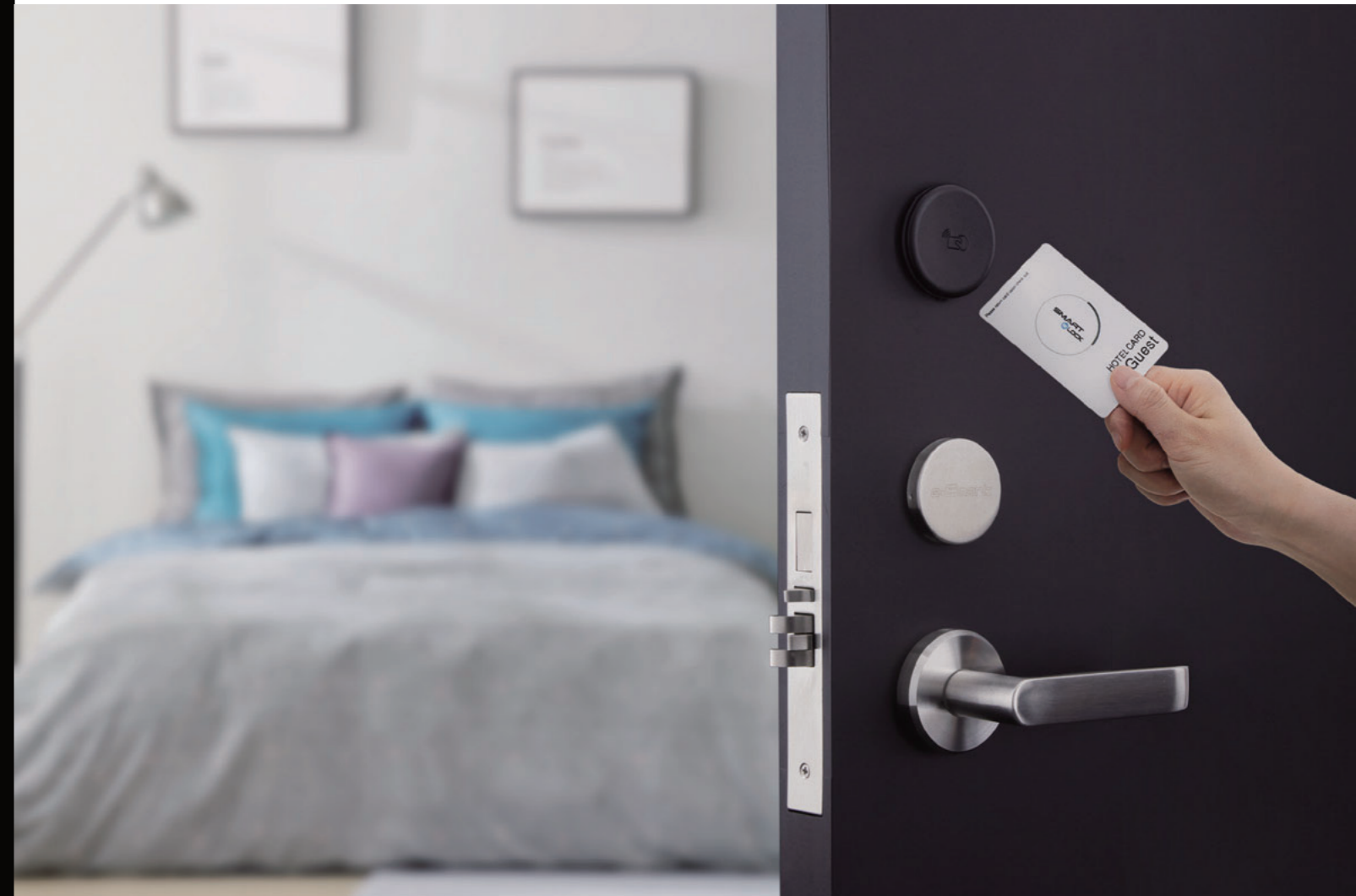

### Feature

- Support RFID technology: Mifare classic & Desfire, ISO14443 Type A/B, ISO15693
- Support mobile key (BLE 4.0 or higher)
- BLE/ZIGBEE Unique security key by AES128 security algorithm
- Audit trail up to 2,000 events by RFID card or Smartphone
- Mortise standard: ANSI/EURO
- Support Dead bolt
- Provide Intrusion alarm
- Door Open/Close detection Sensor (Optional)
- Provide Ajar alarm
- Support Panic release: Deadbolt and latch are automatically retracted by inside handle for easy regress in emergency situations
- Mechanical override: Hidden cylinder key inside
- Lock Management by mobile app (Master key/FW update/Audit Trail/Battery Status check/etc.)
- Power Source : 1) Battery life: 18months and more (AA x 4)  
2) Wired Power (12V) - Optional
- Certifications: CE, FCC, KC approved

# Diamond HP100

## • Color options

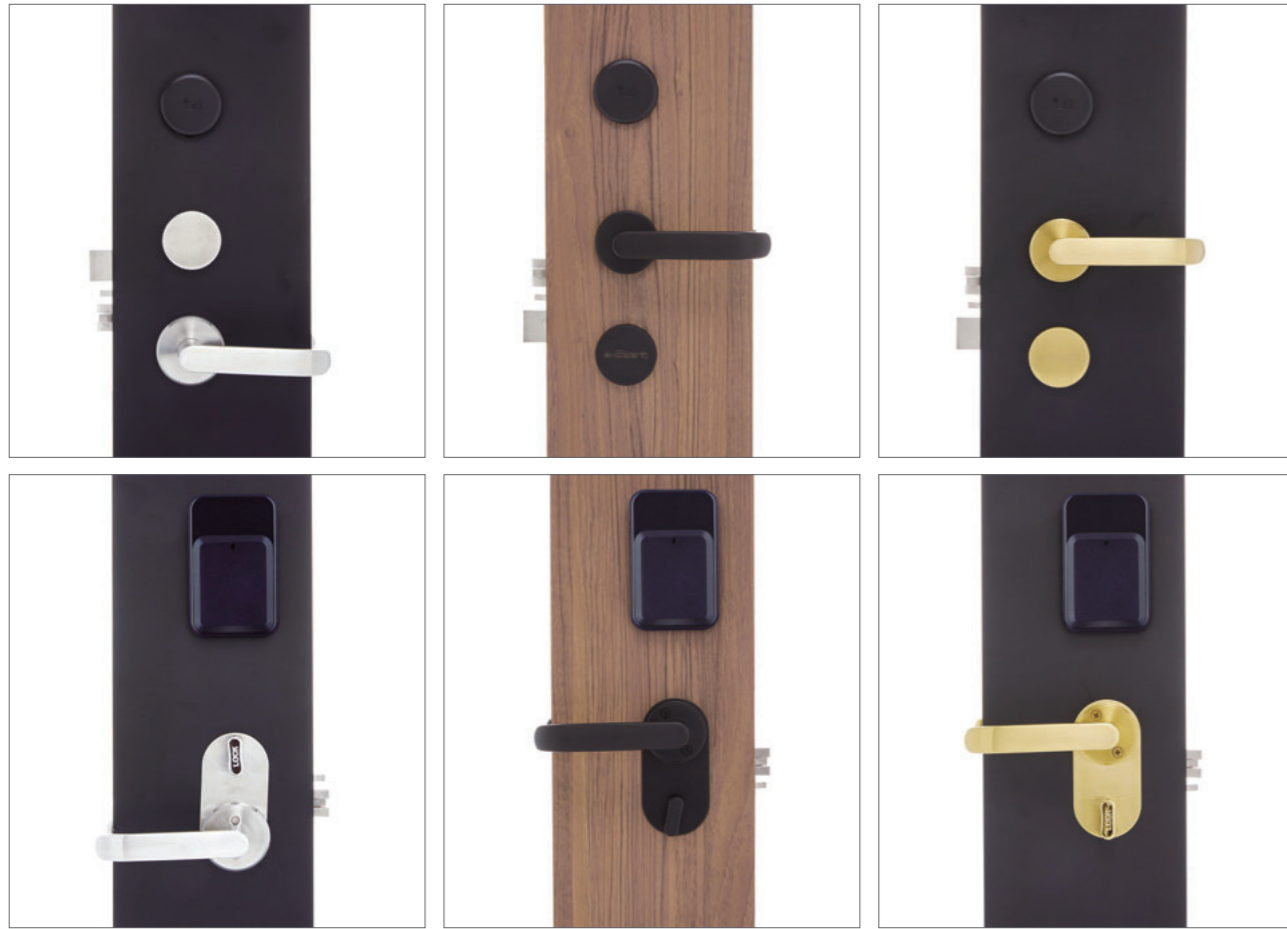

< SILVER >

< BLACK >

< GOLD >

## • Mortise Options

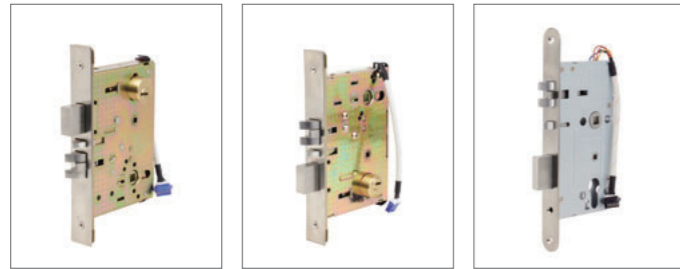

ANSI(Top)

ANSI(Bottom)

EURO #6

## • Handle Options



L1 type

L2 type

7 size type

J type

Z type

P type

T type

## • Dimensions

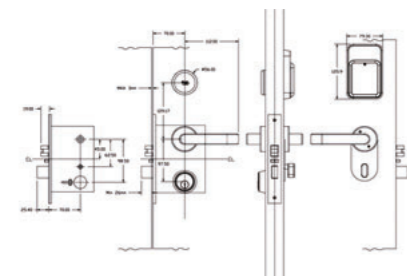

## • Installation

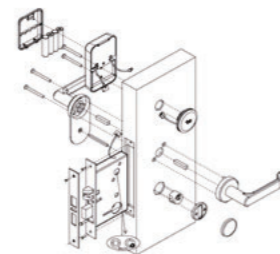

Platinum HP200 / HP200N



**Feature**

- Support RFID technology: Mifare classic & Desfire, ISO14443 Type A/B, ISO15693
- Support mobile key (BLE 4.0 or higher)
- BLE/ZIGBEE Unique security key by AES128 security algorithm
- Support PIN code(Smart code)
  - Use 8~12 pin code which is provided with HashCode algorithm from the client software or cloud server
- Audit trail up to 2,000 events by RFID card or Smartphone
- Mortise standard: ANSI/EURO
- Support Dead bolt
- Provide Intrusion alarm
- Door Open/Close detection Sensor (Optional)
- Provide Ajar alarm
- Support Panic release: Deadbolt and latch are automatically retracted by inside handle for easy regress in emergency situations
- Mechanical override: Hidden cylinder key inside
- Lock Management by mobile app (Master key/FW update/Audit Trail/Battery Status check/etc.)
- Power Source : 1) Battery life: 18months and more (AA x 4)
  - 2) Wired Power (12V) - Optional
- Certifications: CE, FCC, KC approved

## Platinum HP200 / HP200N

### • Color options



< SILVER >

< BLACK >

< GOLD >

### • Mortise Options

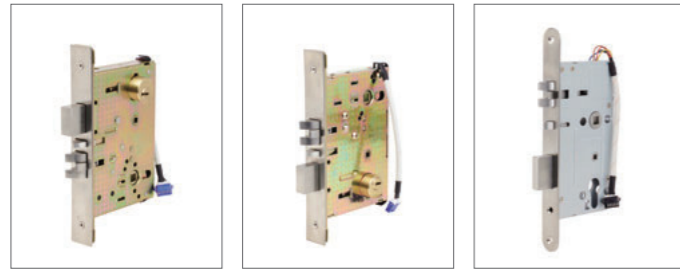

ANSI(Top)

ANSI(Bottom)

EURO #6

### • Handle Options



L1 type

L2 type

7 size type

J type

Z type

P type

T type

### • Dimensions

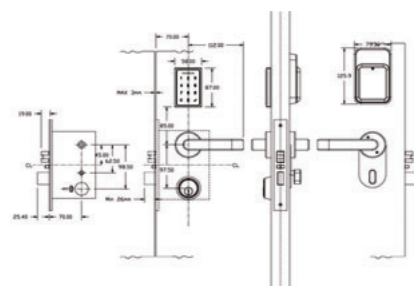

### • Installation

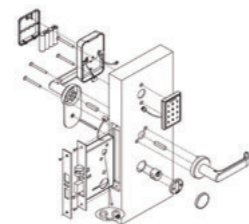

#### Convenience of Smart Code for Group of Guests

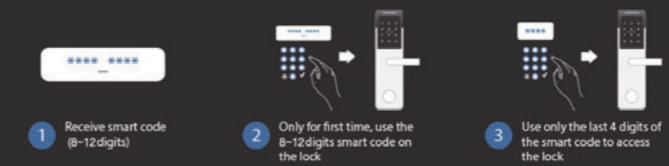

- Suitable for group of guests or multiple customers who are staying in one room
- No Guest card needed – cost save

#### Smartcode features:

- ✓ Automatically create the pin code only for the duration of stay.
- ✓ 8~12 digit PIN code by e-mail or SMS
- ✓ Work offline, no network connection needed
- ✓ No contact for check-in or key exchange
- ✓ Bypass front desk for registration

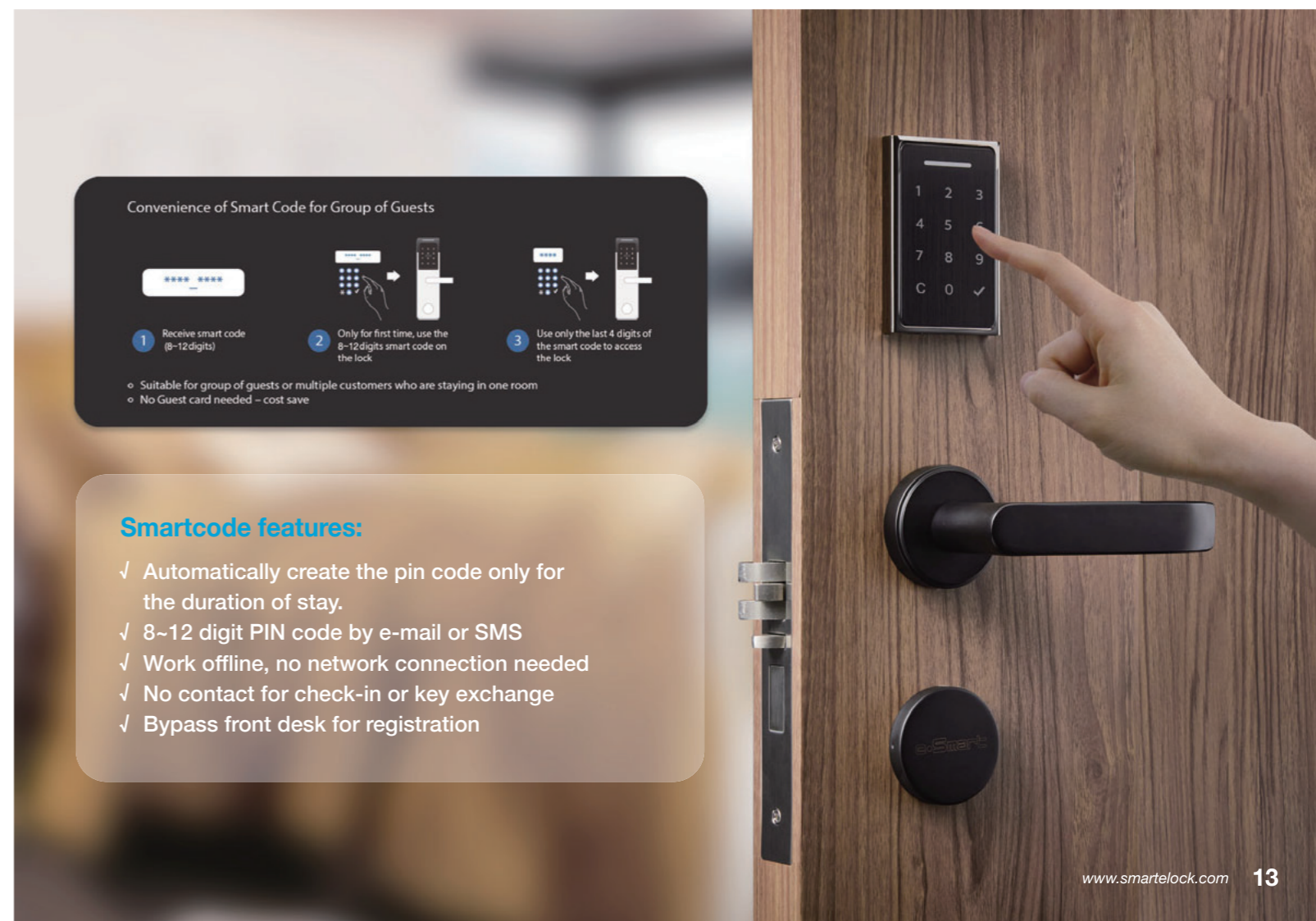

Platinum HP200E / HP200EN



**Feature**

- Support RFID technology: Mifare classic & Desfire, ISO14443 Type A/B
- Support mobile key (BLE 4.0)
- Support E-display (DND/MUR/Room Number/etc.,)
- BLE/ZIGBEE Unique security key by AES128 security algorithm
- Audit trail up to 2,000 events by RFID card or Smartphone
- Mortise standard: ANSI/EURO
- Support Dead bolt
- Provide Intrusion alarm
- Door Open/Close detection Sensor (Optional)
- Provide Ajar alarm
- Support Panic release: Deadbolt and latch are automatically retracted by inside handle for easy regress in emergency situations
- Mechanical override: Hidden cylinder key inside
- Lock Management by mobile app (Master key/FW update/Audit Trail/Battery Status check/etc.)
- Power Source : 1) Battery life: 18months and more (AA x 4)  
2) Wired Power (12V) - Optional
- Certifications: CE, FCC, KC approved



# Platinum HP200E / HP200EN

## • Color options



< SILVER >

< BLACK >

< GOLD >

## • Mortise Options

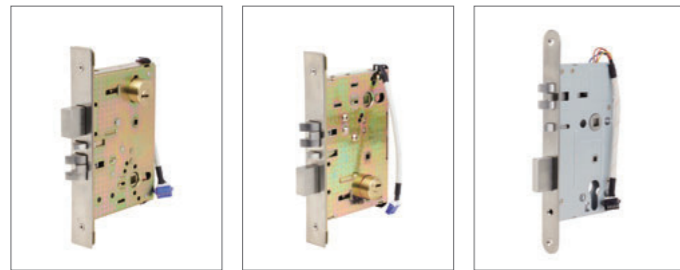

ANSI(Top)

ANSI(Bottom)

EURO #6

## • Handle Options



L1 type

L2 type

7 size type

J type

Z type

P type

T type

## • Dimensions

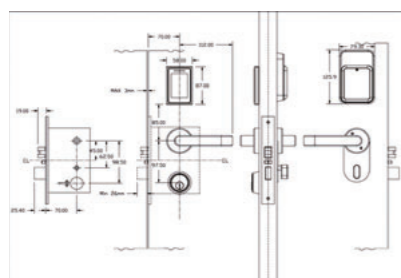

## • Installation

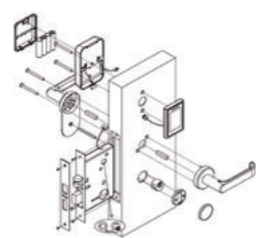

## e-Display Option

- RFID Tag display
- MUR/DND
- Battery Status
- Customized image available.

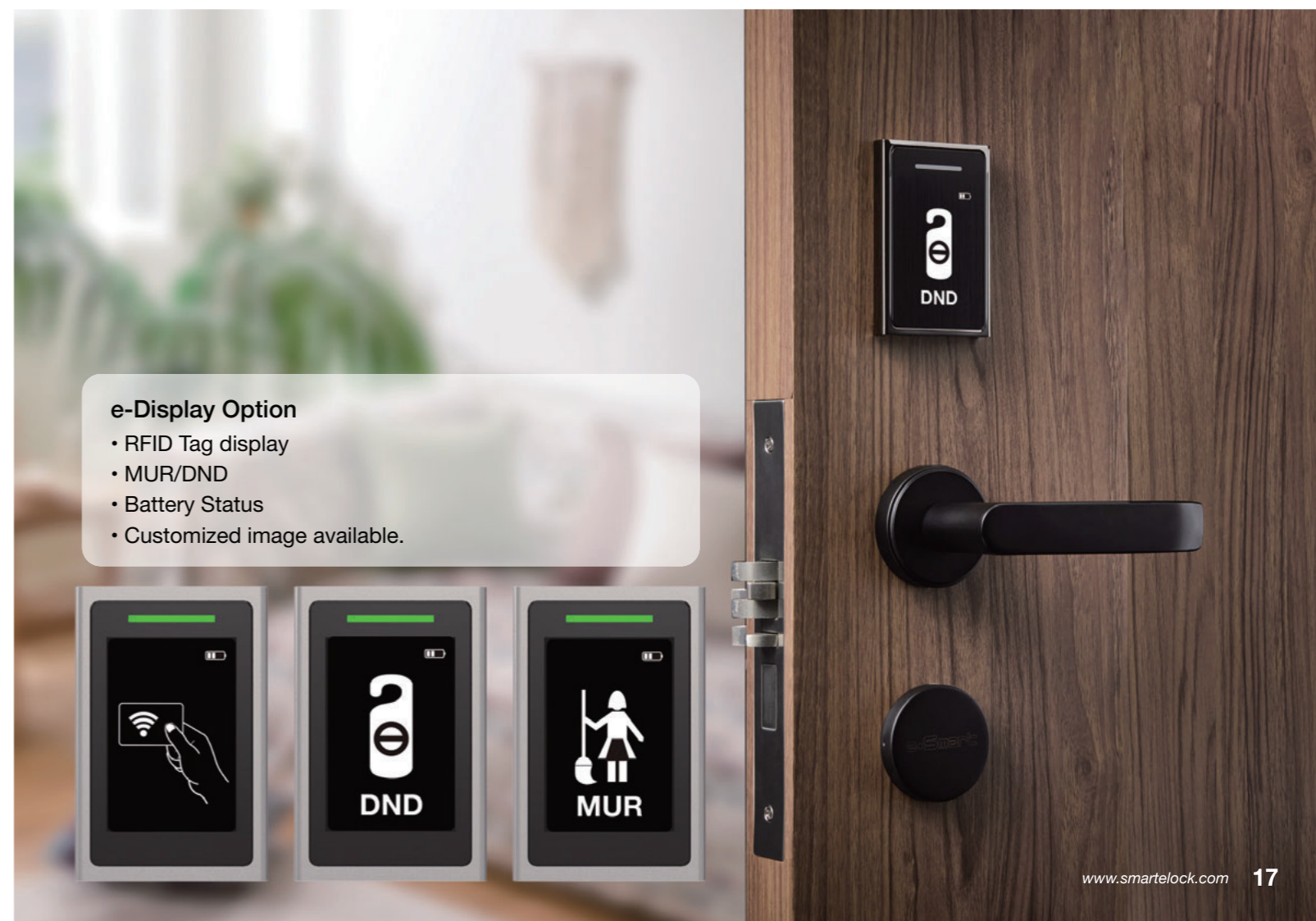

## e-Display Option

- RFID Tag display
- MUR/DND
- Battery Status
- Customized image available.



Mercury HP400-02/03



### Feature

- Support RFID technology: Mifare classic & Desfire, ISO14443 Type A/B, ISO15693
- Support mobile key (BLE 4.0 or higher)
- BLE/ZIGBEE Unique security key by AES128 security algorithm
- Support PIN code(Smart code) Use 8~12 pin code which is provided with HashCode algorithm from the client software or cloud server
- Audit trail up to 2,000 events by RFID card or Smartphone
- Mortise standard: ANSI/EURO
- Support Dead bolt
- Provide Intrusion alarm
- Door Open/Close detection Sensor (Optional)
- Provide Ajar alarm
- Support Panic release: Deadbolt and latch are automatically retracted by inside handle for easy regress in emergency situations
- Mechanical override: Hidden cylinder key inside
- Lock Management by mobile app (Master key/FW update/Audit Trail/Battery Status check/etc.)
- Power Source : 1) Battery life: 18months and more (AA x 4)  
2) Wired Power (12V) - Optional
- Certifications: CE, FCC, KC approved

# Mercury HP400-02/03

## • Color options



< SILVER >

< BLACK >

< GOLD >

## • Mortise Options

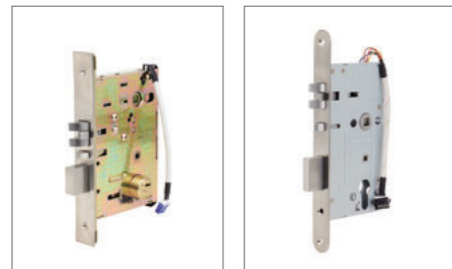

02-ANSI(Bottom)

03-EURO #6

## • Handle Options



L type

C type

7 size type

J type

Z type

P type

T type

## • Dimensions

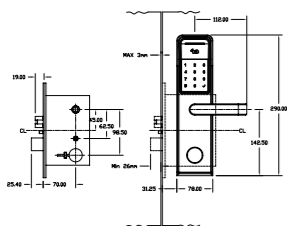

## • Installation

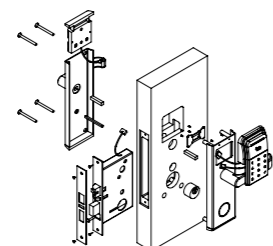

### Convenience of Smart Code for Group of Guests



- Suitable for group of guests or multiple customers who are staying in one room
- No Guest card needed – cost save

### Smartcode features:

- ✓ Automatically create the pin code only for the duration of stay.
- ✓ 8~12 digit PIN code by e-mail or SMS
- ✓ Work offline, no network connection needed
- ✓ No contact for check-in or key exchange
- ✓ Bypass front desk for registration





# Mercury HP400N-01

## • Color options



< SILVER >

< BLACK >

< GOLD >

## • Mortise Options



ANSI(Top)

## • Handle Options



L type

C type

7 size type

J type

Z type

P type

T type

## • Dimensions

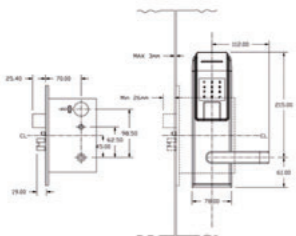

## • Installation

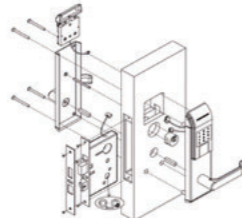

# Mercury HP400N-02/03

## • Color options

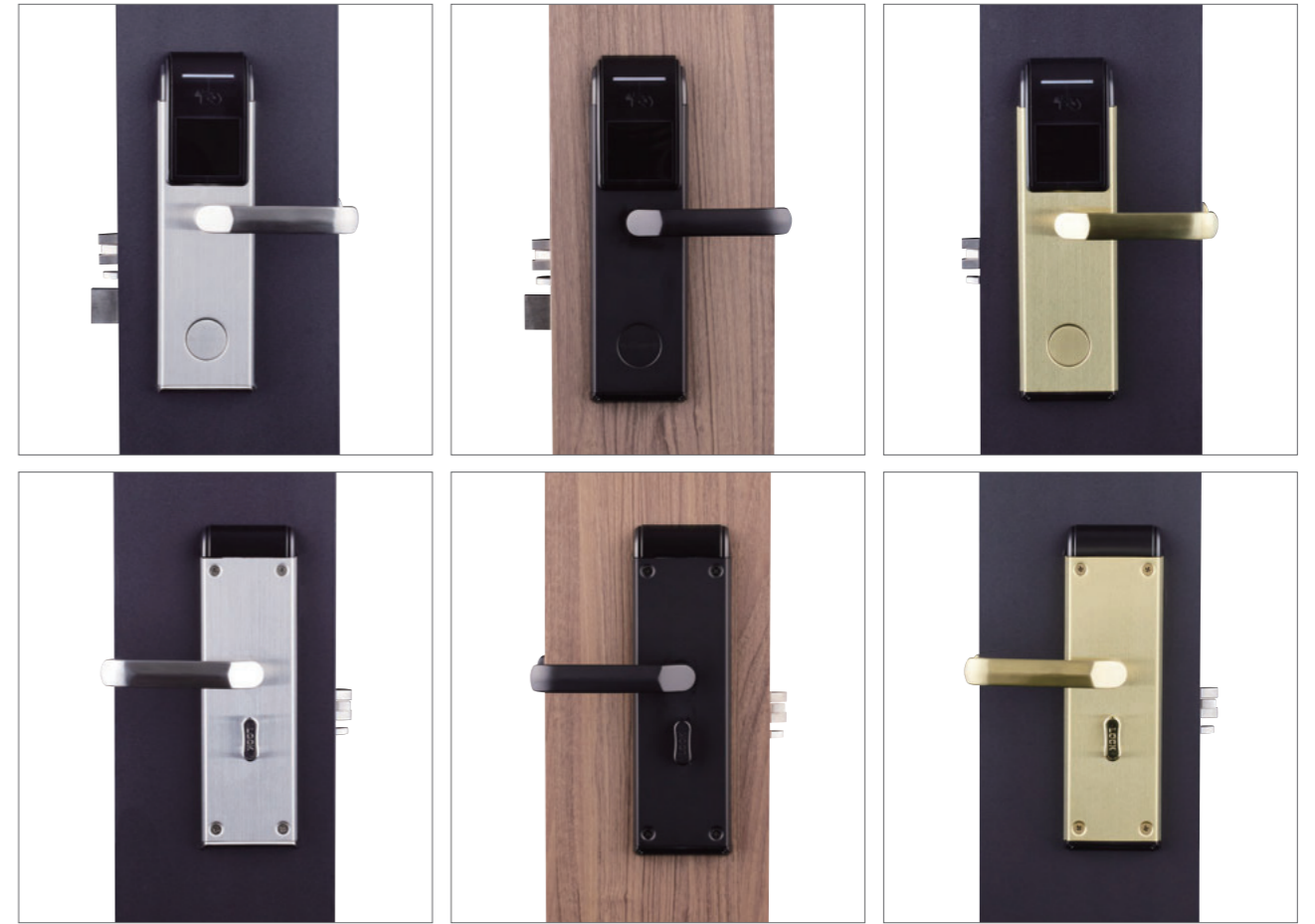

< SILVER >

< BLACK >

< GOLD >

## • Mortise Options

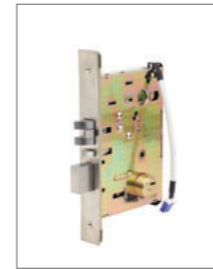

ANSI(Bottom)

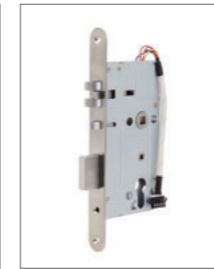

EURO #6

## • Handle Options



L type

C type

7 size type

J type

Z type

P type

T type

## • Dimensions

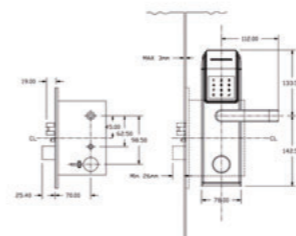

## • Installation

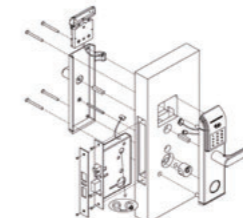



### Feature

- Support RFID technology: Mifare classic & Desfire, ISO14443 Type A/B, ISO15693
- Support mobile key (BLE 4.0 or higher)
- BLE/ZIGBEE Unique security key by AES128 security algorithm
- Support PIN code(Smart code) Use 8~12 pin code which is provided with HashCode algorithm from the client software or cloud server
- Audit trail up to 2,000 events by RFID card or Smartphone
- Mortise standard: ANSI/EURO
- Support Dead bolt
- Provide Intrusion alarm
- Door Open/Close detection Sensor (Optional)
- Provide Ajar alarm
- Support Panic release: Deadbolt and latch are automatically retracted by inside handle for easy regress in emergency situations
- Mechanical override: Hidden cylinder key inside
- Lock Management by mobile app (Master key/FW update/Audit Trail/Battery Status check/etc.)
- Power Source : 1) Battery life: 18months and more (AA x 4)  
2) Wired Power (12V) - Optional
- Certifications: CE, FCC, KC approved

# Mercury HP500-02/03

## • Color options

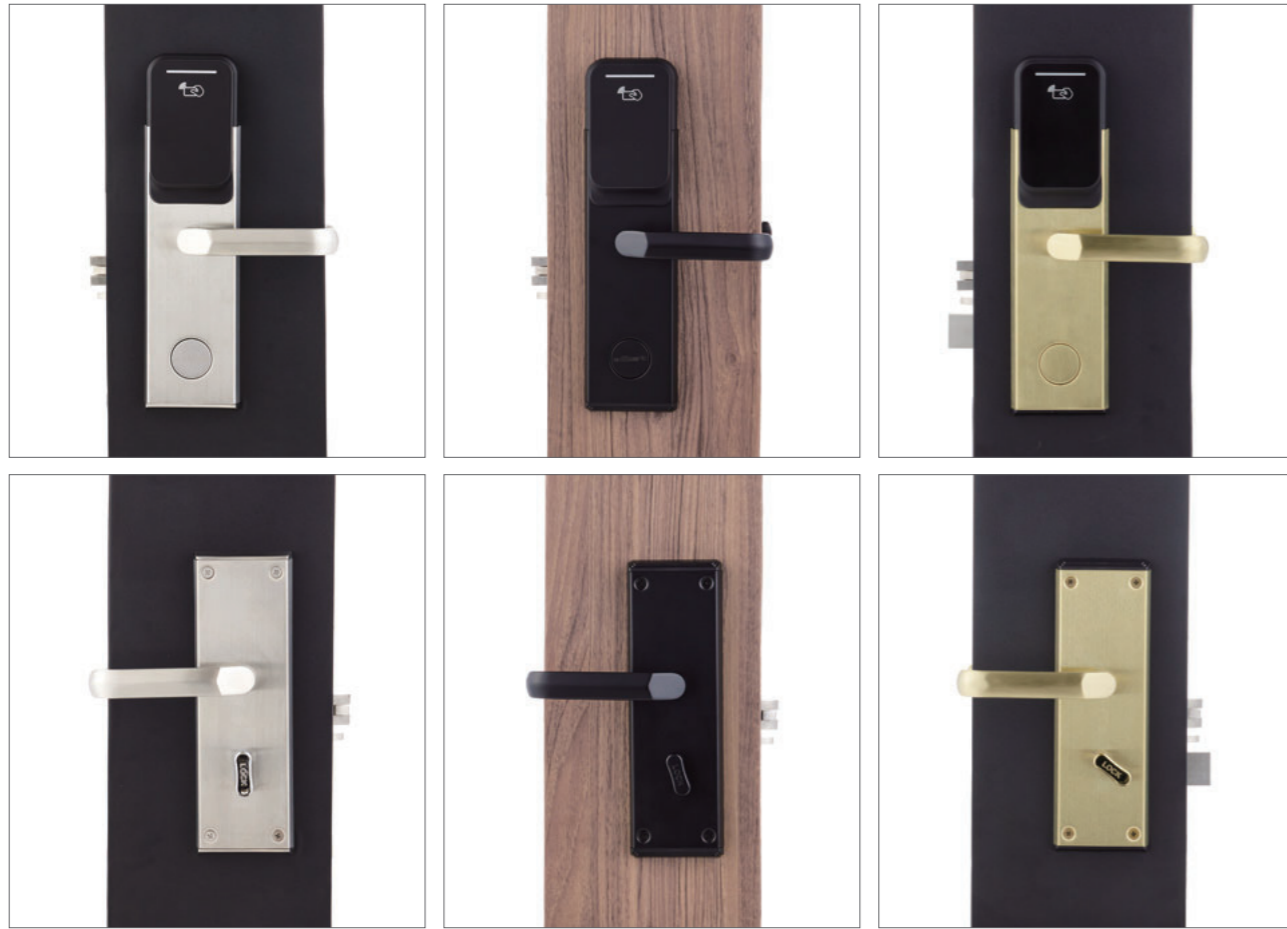

< SILVER >

< BLACK >

< GOLD >

## • Mortise Options

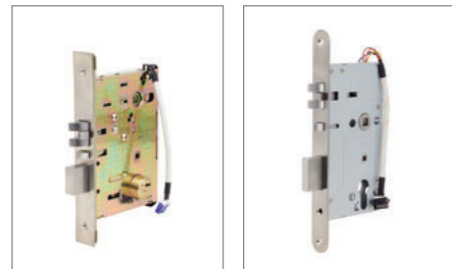

02-ANSI(Bottom)

03-EURO #6

## • Handle Options



L type

C type

7 size type

J type

Z type

P type

T type

## • Dimensions

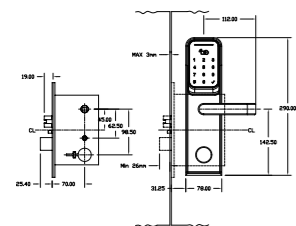

## • Installation

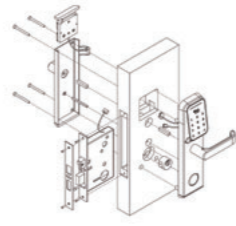

### Convenience of Smart Code for Group of Guests

- 1 Receive smart code (6~10 digits)
- 2 Only for first time, use the 6~10 digits smart code on the lock
- 3 Use only the last 4 digits of the smart code to access the lock

- ✓ Suitable for group of guests or multiple customers who are staying in one room
- ✓ No Guest card needed - cost save

### Smartcode features:

- ✓ Automatically create the pin code only for the duration of stay.
- ✓ 8~12 digit PIN code by e-mail or SMS
- ✓ Work offline, no network connection needed
- ✓ No contact for check-in or key exchange
- ✓ Bypass front desk for registration

# Management Software

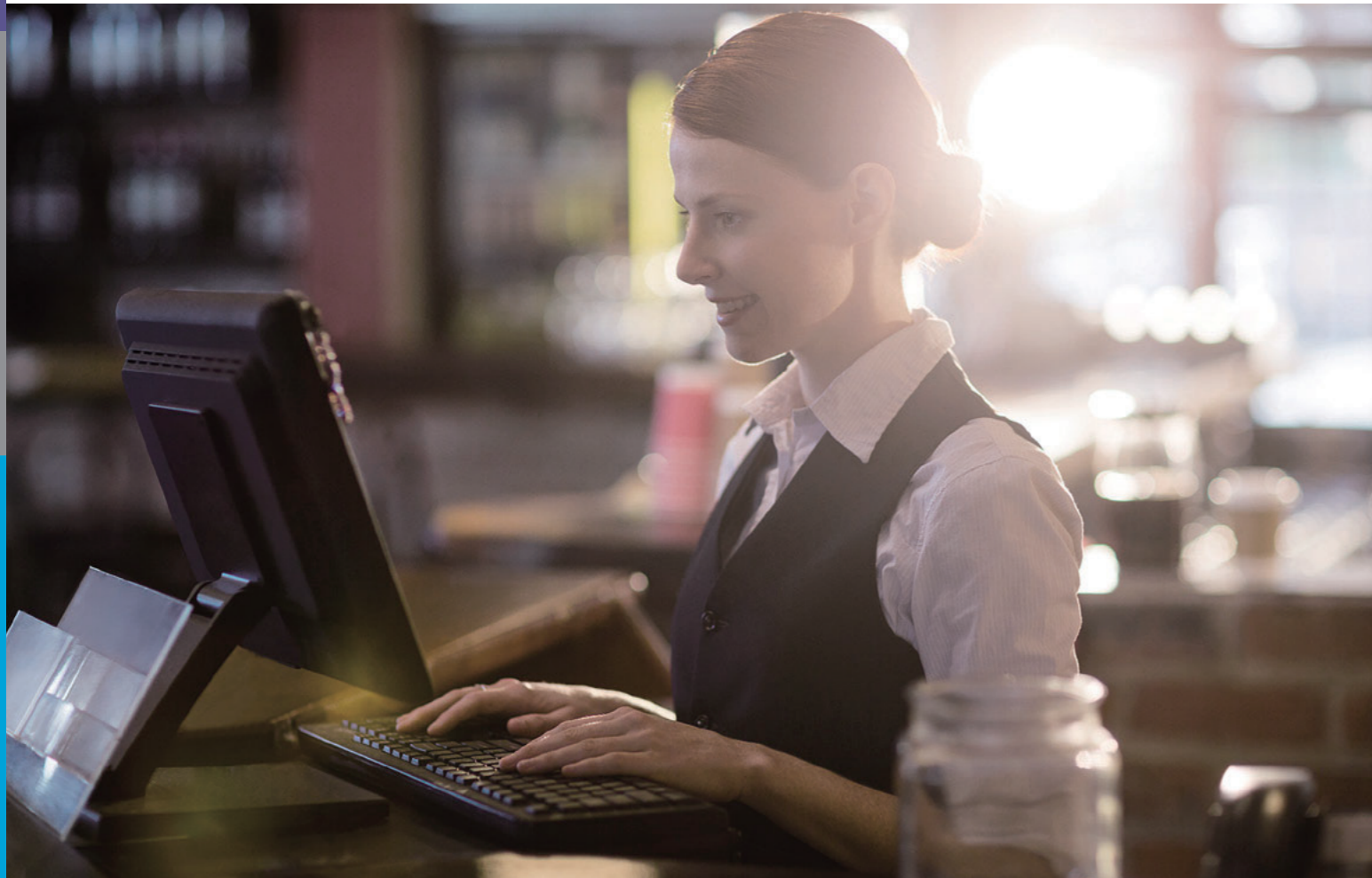

## e-Smart HLKS (For Distributor)

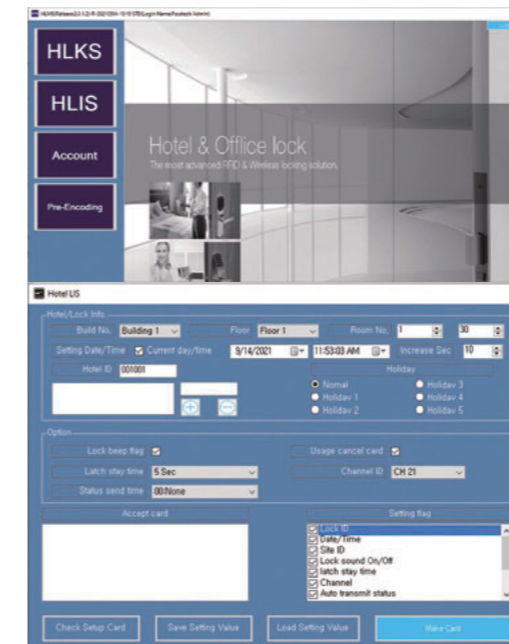

- Key/System Card generation
- Make card blank
- Lock ID, Wireless channel, parameter setting

## e-Smart HMS (For Customer)

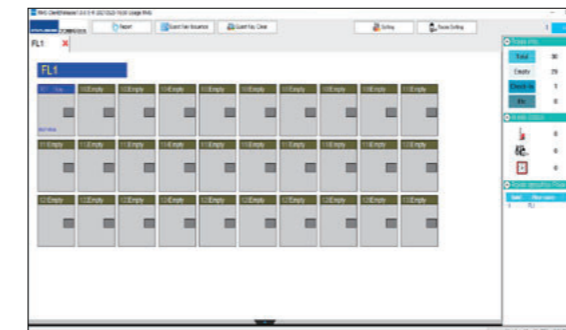

Management software for hotels, resorts, hostels, and other accommodations

- User & Staff account management
- Guest & Staff card issuance
- Auto check-in/out
- Low battery alert, Intrusion alarm
- Audit trail (RFID card: 2000 events / Online: Unlimited)
- Instant extended stay without visiting reception (Online)
- Instant room change without visiting reception (Online)
- Emergency open/close (Online)
- Remote lock status monitoring (Online)
- Remote passage mode activation for a specific room(Online)
- Report a problem with a room by scanning Reporting Card (Online)

## e-Smart MIS (Lock Management APP)

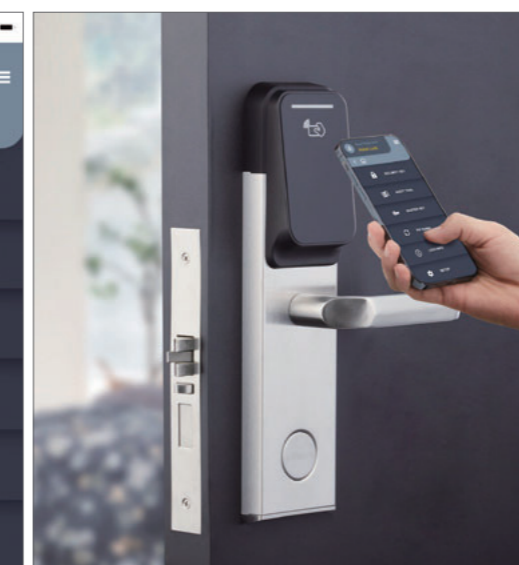
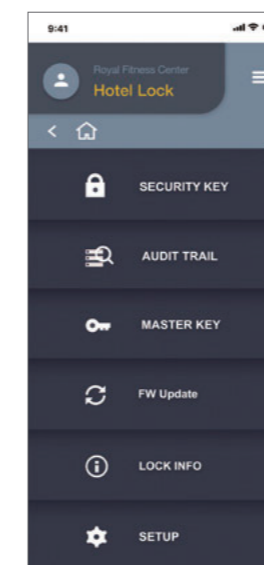

e-Smart locks can be programmed and managed efficiently by smartphone via Smartelock management APP.

- Lock setting
- Maintenance
- Firmware download
- Audit trail
- Lock information check
- Battery status
- Emergency lock open (Master card)



# Technology & Solutions

## Mobile Key and Smart Code

### Mobile Access Key

Experience convenient access to your property by Mobile key generated via Cloud anywhere in the world

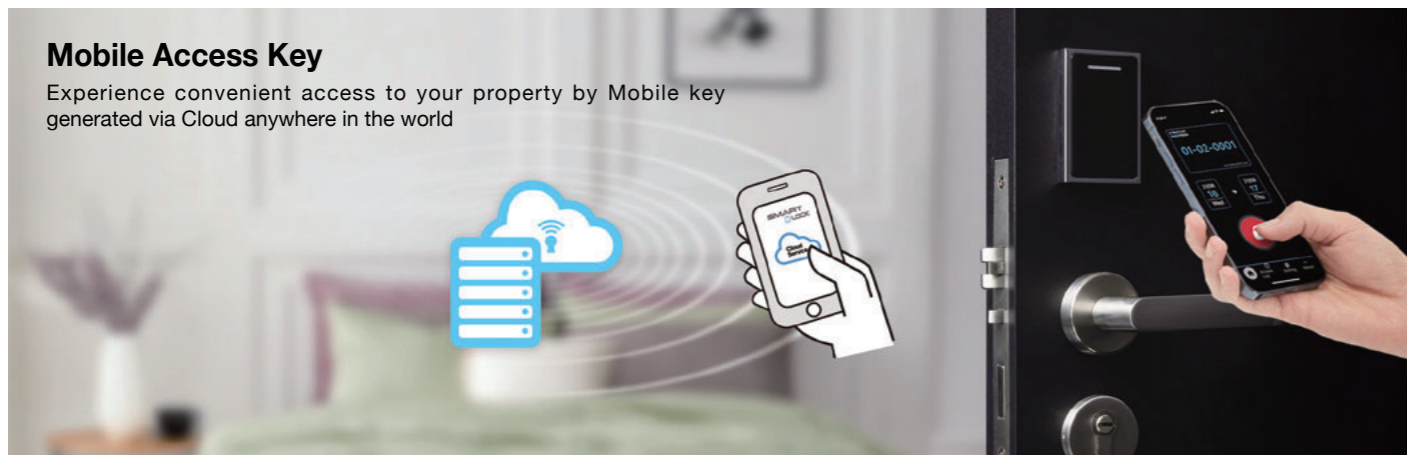

### Smart Code

- ✓ 6-10 digit PIN code by e-mail or SMS
- ✓ Encrypted mobile key which can be used by smartphone
- ✓ Work offline, no network connection needed
- ✓ Operate a lock anytime, anywhere
- ✓ No contact for check-in or key exchange
- ✓ Bypass front desk for registration
- ✓ No guest card needed – cost save
- ✓ No risk of losing keys or cards
- ✓ Fast, easy, and secure



### Control Time Sensitive Smart Code and Mobile key from wherever you are

- Very easy and convenient for you to schedule a smart code and mobile key for each lock via your smartphone or computer
- Simply login the cloud server and select your lock to generate the smart code and mobile key

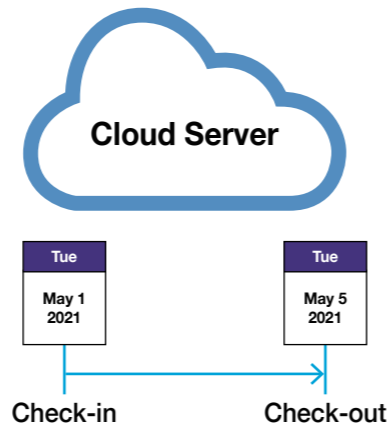

### No Network Connection, No WiFi, No Cellular Phone Network Needed.....

- Smart Code and Mobile key operates in completely offline environment
- No Network Connection Required

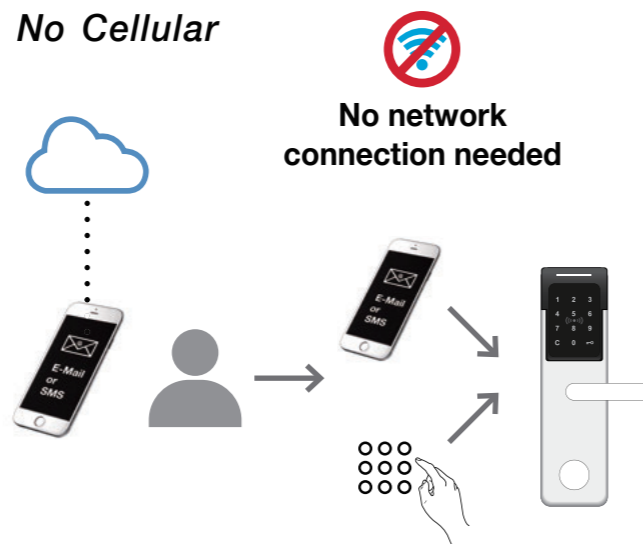

Experience convenient access to your property by Smart code or Mobile key generated via the Cloud anywhere in the world

- 8~12 digit PIN code by e-mail or SMS
- Encrypted mobile key which can be used by smartphone
- Work offline, no network connection needed
- Operate a lock anytime, anywhere
- No contact for check-in or key exchange
- Bypass front desk for registration
- No guest card needed – cost save
- No risk of losing keys or cards
- Fast, easy, and secure

### Convenience of Smart Code for Group of Guests

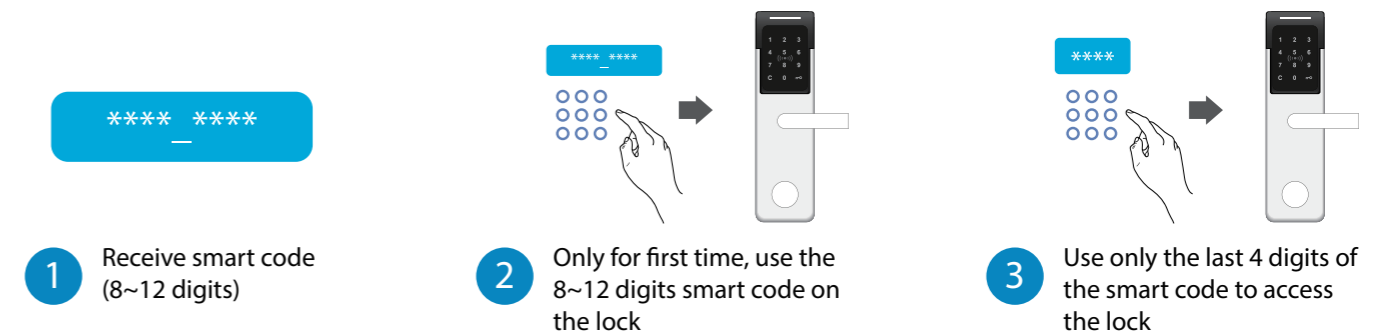

Suitable for group of guests or multiple customers who are staying in one room  
No Guest card needed – cost save

### How it works

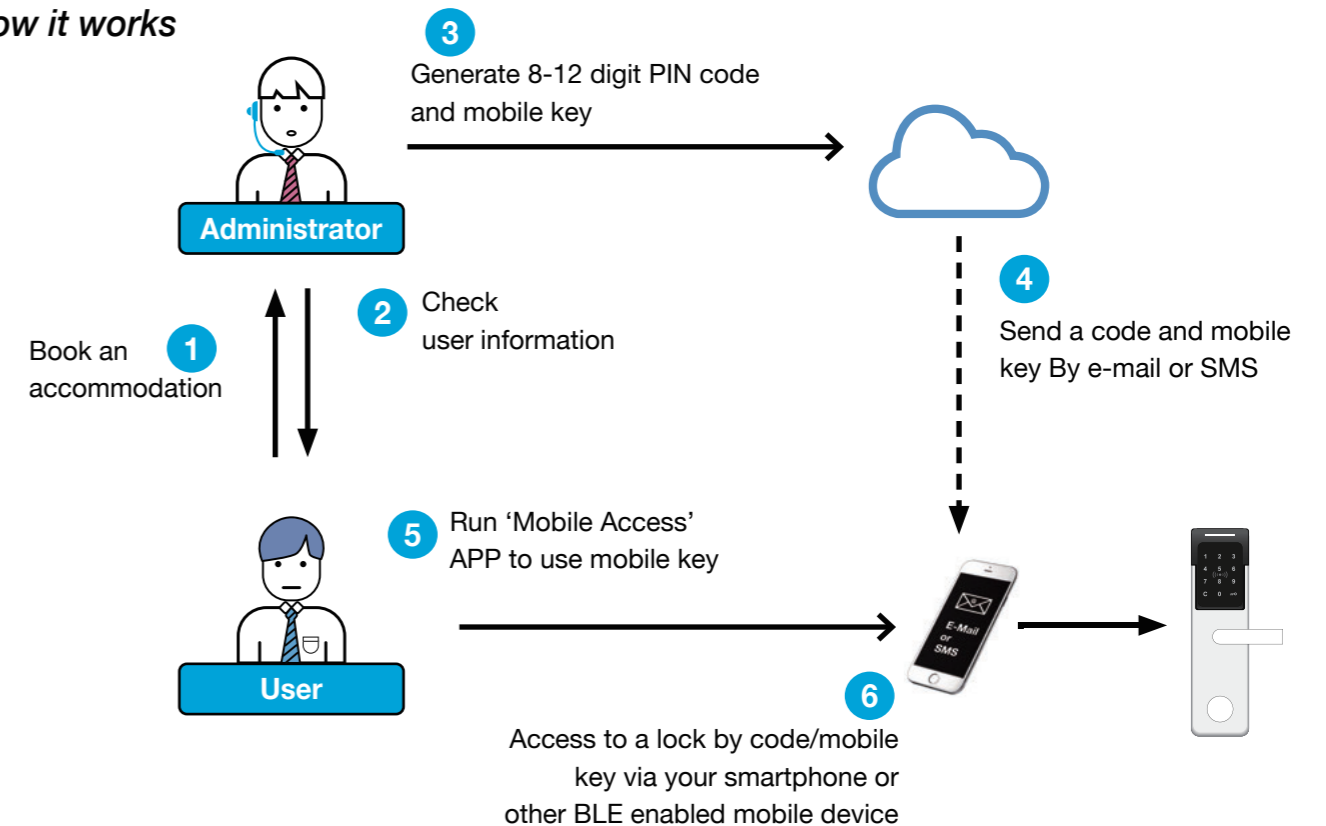

## 3rd Party Interface

### 3rd Party Interface

SMARTeLock's hotel lock system supports 3rd Party Interface such as property management system(PMS), guest room management system(GRMS), and room intercom system.



• SMARTeLOCK's hotel lock system supports 3rd Party Interface such as property management system(PMS), guest room management system(GRMS), and room intercom system.

### PMS interface

- Support PMS interface that is used in the hotel and provide SMARTeLock's unique total management solution that is for reservation & room management, issuance of guest card, and so on.
- Easily manage your hotel from the front desk using room/staff card issuance program module which is optimized for PMS interface.

### GRMS interface

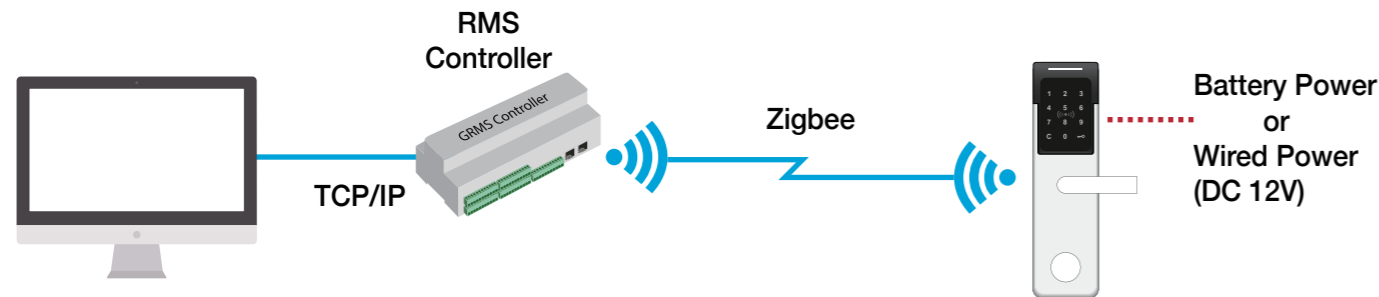

- ※ Provide room/staff card issuance SDK in order to support integration with existing GRMS solution for the total solution.
- ※ If you are using Zigbee stack in your RMS controller or other devices, it can communicate with our door lock with Zigbee.

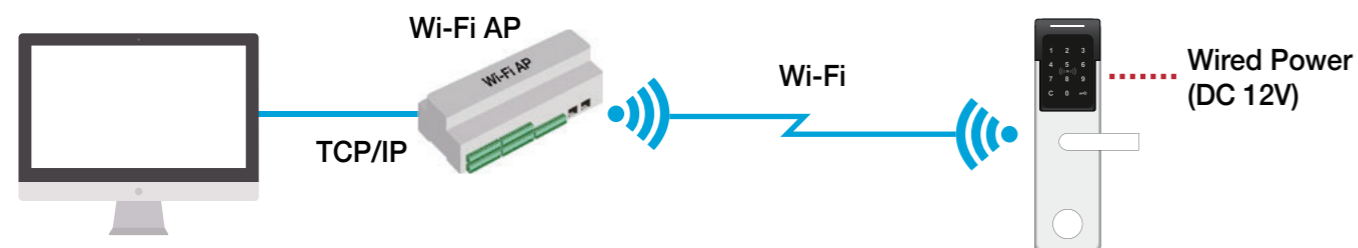
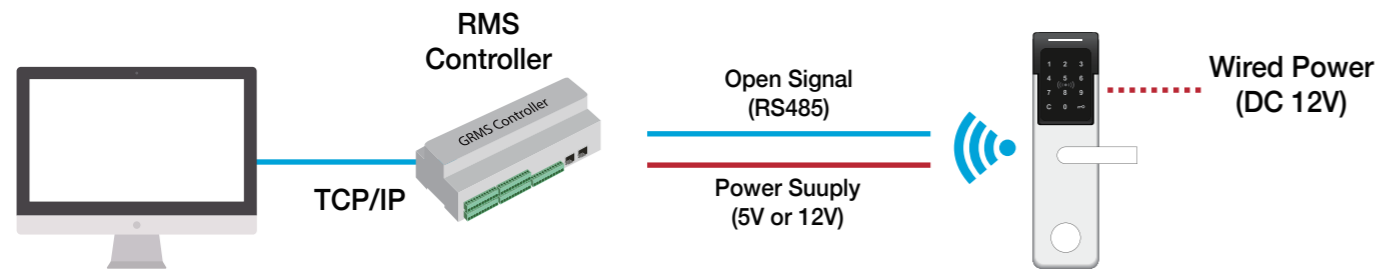

- ※ Door locks can be interfaced with 3rd Party GRMS by using RS485 communication and wired power supply.
- ※ By using commercial Wi-Fi access point, door locks can be interfaced and controlled/monitored wirelessly.

## Room intercom interface

- Control it by communicating Door lock with wireless Zigbee module or wired communication module on an Intercom that was installed previously.

### Type 1

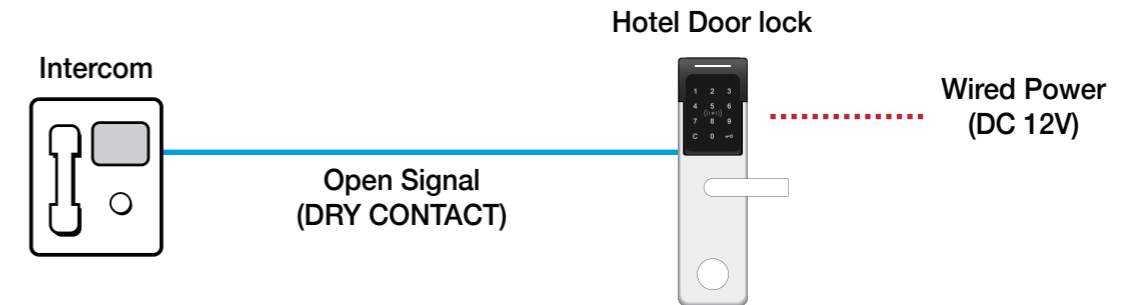

- ※ Needs Wiring work (1 Line) from Intercom to Hotel door lock.

### Type 2

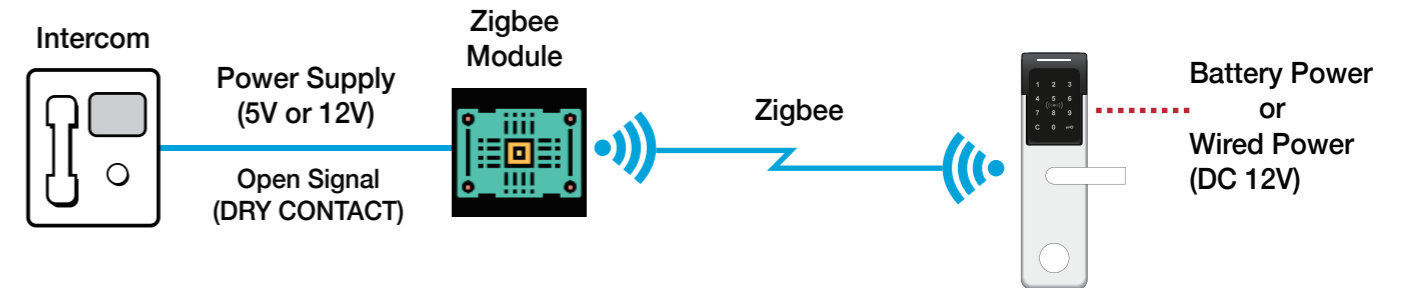

- ※ Doesn't need Wiring work from Intercom to Hotel door lock.

## Mobile SDK

- Third-party software companies and end-users are allowed to operate and manage SMARTeLock Hotel door locks by utilizing e-Smart locking solution. API(Application Programming Interface) to control access within their own applications.
- Customer can create card issuance and management system for applications

SDK Packages	Provided by SMARTeLOCK	Developed by Customer
HMS Card Issuance System	<ul style="list-style-type: none"> <li>• DLL for Card Issuance</li> <li>• API document for Card Issuance</li> <li>• API sample program for Card Issuance</li> </ul>	<ul style="list-style-type: none"> <li>• Card Issuance program needs to be developed and interfaced by customer</li> </ul>
Mobile User App For Anroid / iOS	<ul style="list-style-type: none"> <li>• SDK for Android/iOS</li> <li>• Sample project (program source) for Android/iOS</li> </ul>	<ul style="list-style-type: none"> <li>• Mobile app for Android/iOS needs to be developed by customer</li> </ul>

# Wireless Online Solution

## INNOVATIVE, SMART and SECURE SMARTeLOCK TOTAL LOCKING SOLUTION

SMARTeLOCK provides you the most efficient and reliable wireless locking solution suitable for hotels, resorts, smart offices, schools, gyms, and other facilities.



There are 4 solutions in Smartelock's online solutions such as, 1) Wireless online Zigbee communication using SMARTeLock's AP, 2) Wireless online Zigbee communication using 3rd party GRMS controller, 3) hard-wired RS485 communication using 3rd party GRMS controller, and finally, 4) wireless online communication solution using commercial Wi-Fi AP.

By using these solutions, SMARTeLock offers complete hard-wired / wireless online solution that can be applied to various circumstances.

### 1) Wireless online Zigbee communication using SMARTeLock's AP

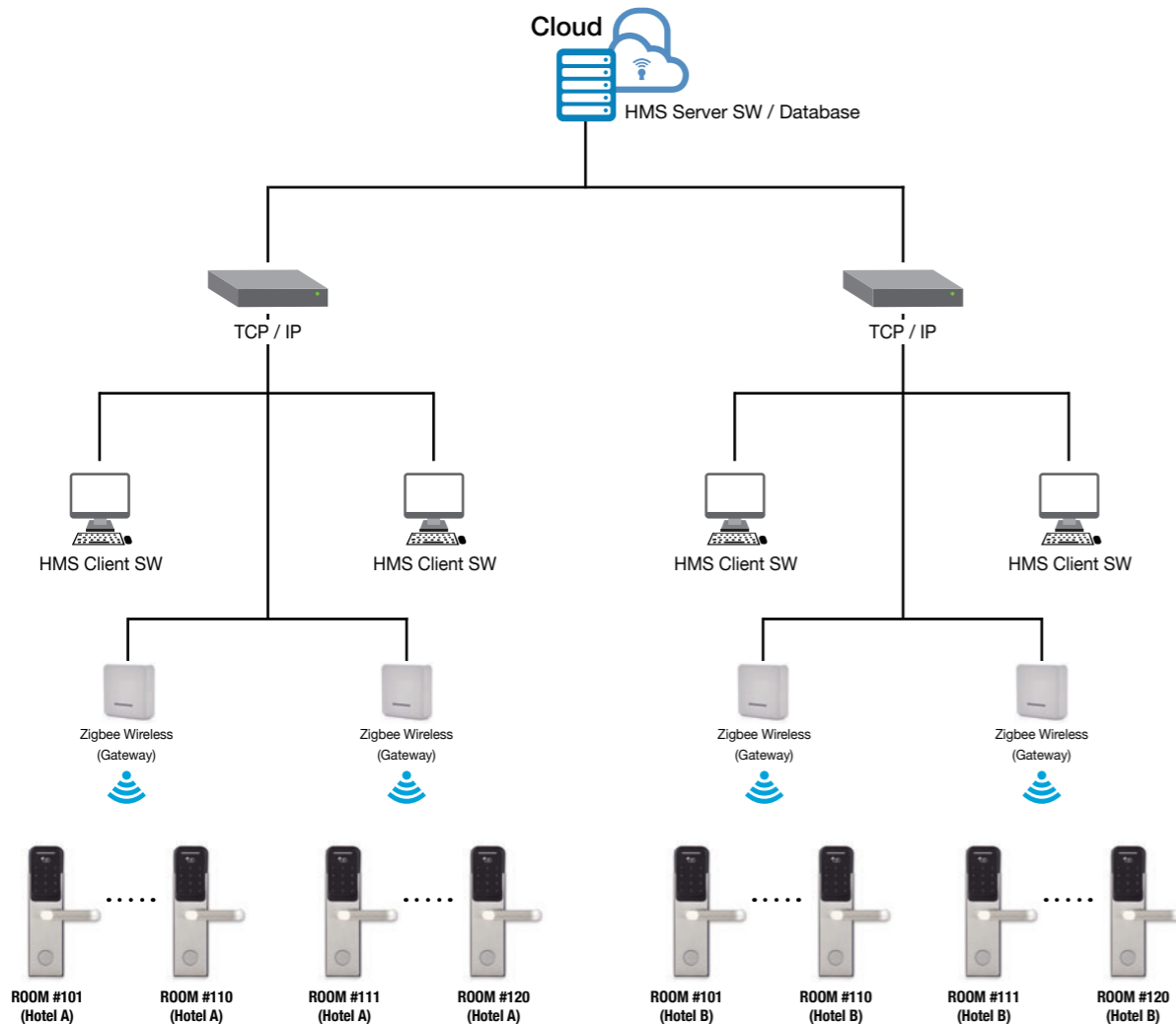

### 2) Wireless online Zigbee communication using 3rd party GRMS controller

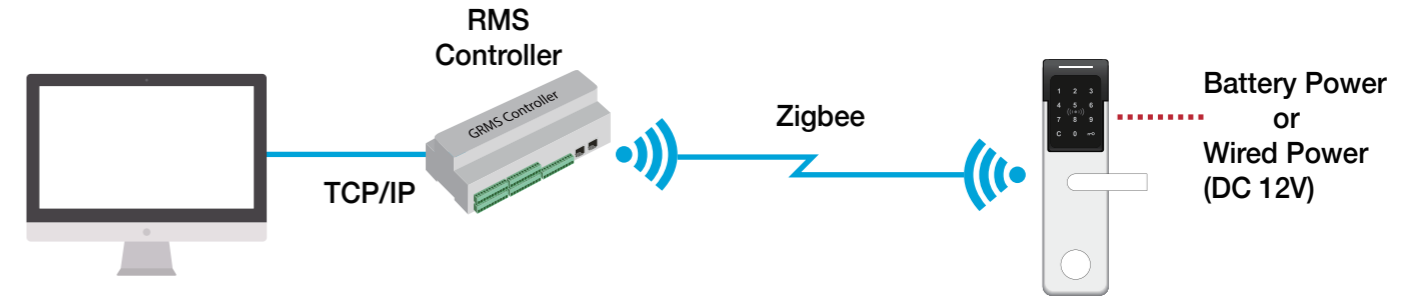

- \* Provide room/staff card issuance SDK in order to support integration with existing GRMS solution for the total solution.
- \* If you are using Zigbee stack in your RMS controller or other devices, it can communicate with our door lock with Zigbee.

### 3) Hard-wired RS485 communication using 3rd party GRMS controller, and finally

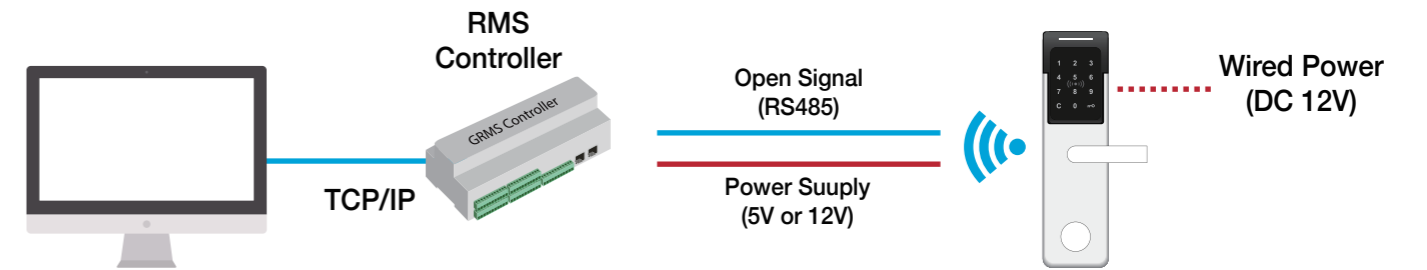

### 4) Wireless online communication solution using commercial Wi-Fi AP

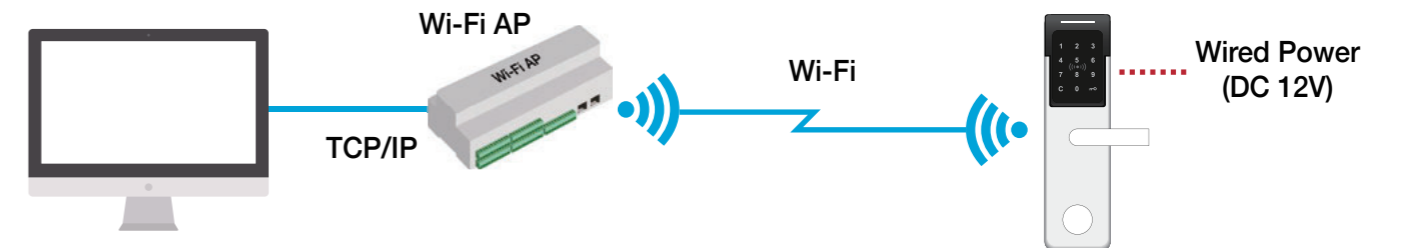

## Comparison Table

Features	Standalone Offline	e-Smart HMS Online
<b>Audit Trail</b>	2,000 events (Card) Need to visit the door	Unlimited events(Online) Remote Online Audit Trail
<b>Low battery status</b>	Need to visit the door	Remote Online Low Battery status check
<b>Extension of Stay</b>	Need to visit the reception to extend	Remote Online stay extension without visiting reception
<b>Room Change</b>	Need to visit the reception to change	Remote Online room change without visiting reception
<b>Real time room control &amp; monitoring</b>	Need to visit the door	Remote Online control & monitoring
<ul style="list-style-type: none"> <li>• Room status Monitoring</li> <li>• Lock/Card blocking</li> <li>• Lock opening/closing</li> <li>• Ajar alarm</li> </ul>		

# System Components & Peripheral Equipments

## INNOVATIVE, SMART and SECURE SMARTeLOCK TOTAL LOCKING SOLUTION

SMARTeLOCK provides you the most efficient and reliable wireless locking solution suitable for hotels, resorts, smart offices, schools, gyms, and other facilities.



## Seamless Unlock Innovation

Contactless check-in solutions with IoT & wireless online technology

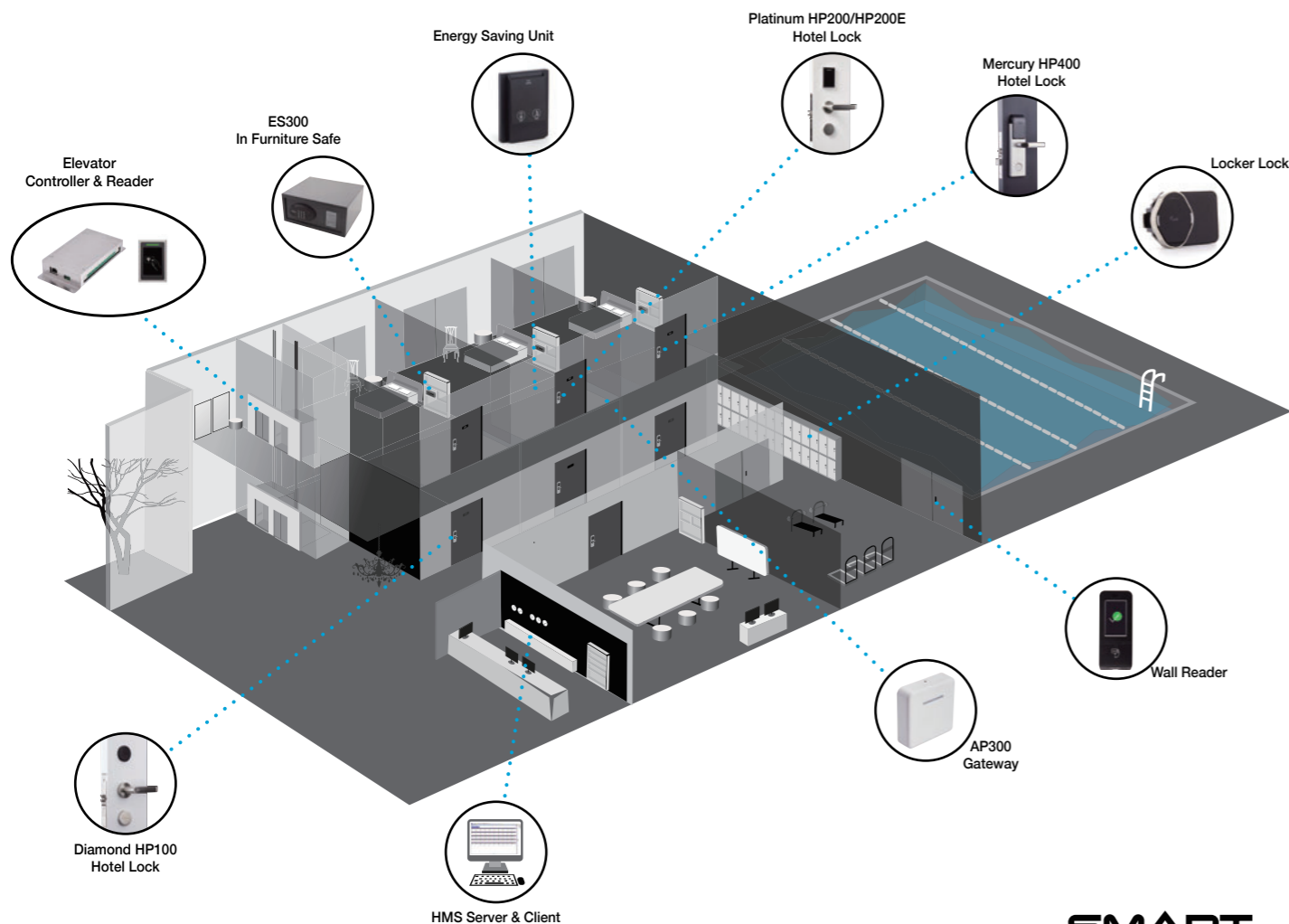

## Accessories

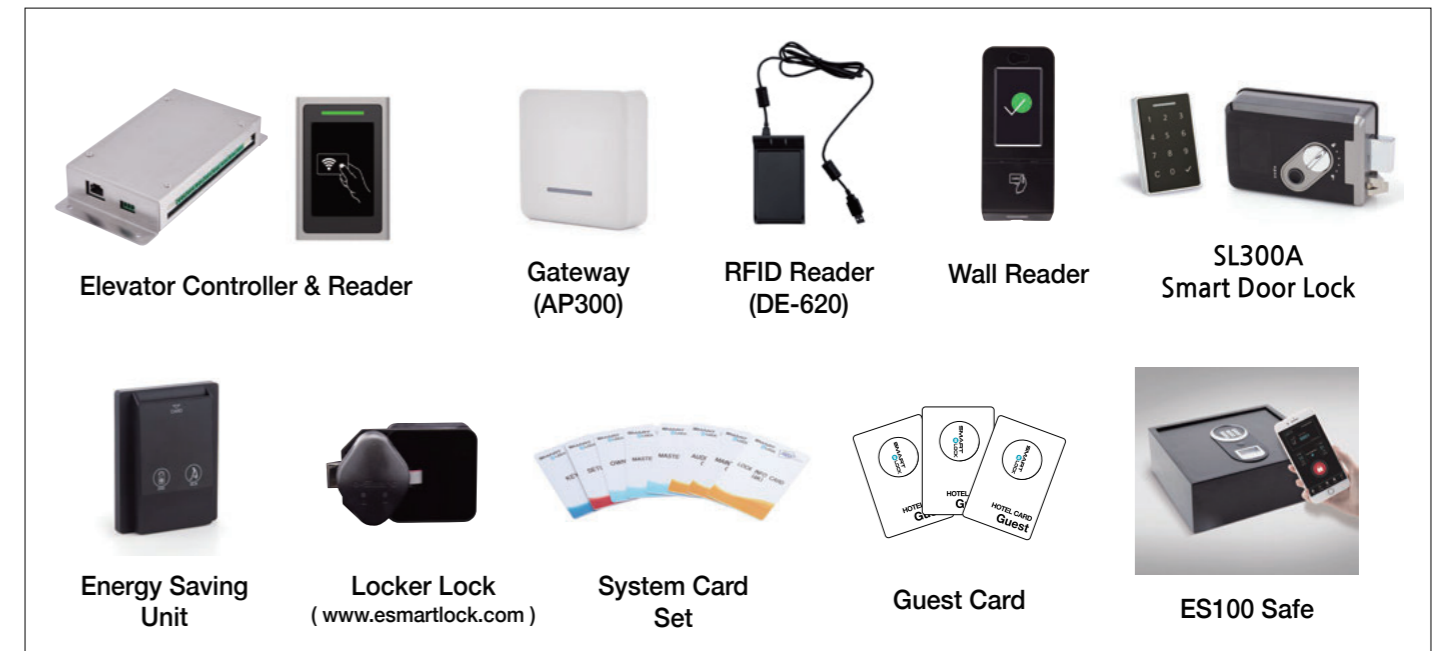

### Elevator Controller



ITEM	SPECIFICATION
Control Floors	16 Floors (Max. 64 Floor extensible)
Communication to the reader	RS-232
Indicator	LED
Power Supply	DC 12V
Dimension	203.4 x 94.4 x 32.7 (mm)
Operation temperature	-10°C~ 60°C
Certificate	CE/FCC/KC

### Elevator Reader



ITEM	SPECIFICATION
Communication to the controller	RS232(Controller)
Security	AES 128
User Credentials	RFID CARD (ISO14443 A/B, Mifare, ISO15693), Optional - Mobil key / QR code
Indicator	Buzzer, LED
Power Supply	DC 12V
Dimension	57 x 87 x 11 (mm) - TBD (Flat type)
Operation temperature	-10°C~ 60°C
Certificate	CE/FCC/KC

### Gateway (AP300)

	ITEM	SPECIFICATION
	Communication with Server	TCP/IP (standard) 2.4Ghz Wireless(ONLINE LOCK COMM)
	Material	Polycarbonate
	Security	AES128
	Indicator	LED
	Effective range	About 50 meters in open area (without barrier)
	Communication Frequency with locks	2.4GHz IEEE 802.15.4 Compliant RF Transceiver 40-50M (Between Lock and AP)
	Dimension	101.60 x 101.60 x 27.50 (mm) - AP300
	Input Power	DC 12V Adapter, POE (IEEE802.3af)
	Operation temperature	0°C ~ 50°C (Operating), -40°C~85°C(Storage)
Certificate	CE, FCC	

### DE-620 RFID Reader

	ITEM	SPECIFICATION
	RF card protocol	ISO014443 A/B, Mifare, FeliCa, ISO-18092, ISO-15693 /
	PC interface	USB 2.0
	Input power	DC5V, 200mA
	Operation temperature	0°C~ 50°C

### Wall Reader

	ITEM	SPECIFICATION
	RF card protocol	ISO 14443 A/B, Mifare, DESFire, Mobile Key(BLE) - Optional
	Frequency	13.56 MHz
	LCD	4.3"TFT wide(800X480)
	Touch	Resistive touch
	Dimension	163*65*35mm
	Input power	DC9~24V (9V/2A)
Operation temperature	-10 ~ 60°C	

### SL300A Smart Door Lock

	ITEM	SPECIFICATION
	Power	DC 4.5V
	Credential	RFID card, Mobile Key, Smartcode
	Communication Protocol	1. RFID Card: ISO014443 A/B, Mifare, Desfire 2. Mobile Access: BLE 4.0

### Locker Lock(ZP100)

	ITEM	SPECIFICATION
	RF card protocol	ISO014443 A/B, Mifare, FeliCa, ISO-18092, ISO-15693
	Input power	4 * AA Alkaline batteries
	Operation temperature	0°C~ 50°C



### System Card Set

	ITEM	SPECIFICATION
	RF card protocol	ISO014443 A/B, Mifare, FeliCa, ISO-18092, ISO-15693
	Operation temperature	0°C~ 50°C

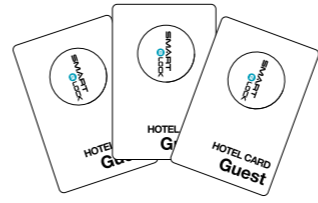
### Guest card

	ITEM	SPECIFICATION
	Dimension	ISO 7816 (85.6x53.98x0.76mm)
	RFID chip	ISO 14443 type A / B :Mifare, Desfire & additional cards on request
	Logo	Customer logo to be printed on request
Operation temperature	0°C~ 50°C	

### In Furniture Safes

Model	ES100	ES300
Picture		
External size	150(H) x 410(W) x 350(D) (mm)	200(H) x 400(W) x 300(D) (mm)
Weight	10KG	12KG
Opening Type	Top opening	Front opening
PIN code	4~6 digits	
RFID credentials	MIFARE Classic & DESFire as default, ISO 14443 Type A/B, NFC and more on request	
Mobile access (Optional)	E-Smart Mobile ID, Mobile Sync, Mobile Key	
Emergency opening	Mechanical override key, Master code	
Certification	CE, FCC	
Power Supply	4 x AA Alkaline batteries	
LED display	O	O
Keypad backlight	O	X

## Energy Saving Unit



### Energy Saving Unit

SmarteLock's Energy saving unit(Key holder) solution provides various smart features such as, differentiating card type to limit use of in-room electrical devices to save energy and guest in-room detection through communicating with various in-room devices for front desk to monitor.

Compatible with e-Smart mobile key, SmarteLock's Energy saving unit(Key holder) detects e-Smart mobile key usage and allows full-feature of energy saving unit(Key holder) without use of RFID card.

#### Features

- : Save energy when the guests are not in their room.
- : Verify the guest card/staff card/dummy card intelligently and control separately.
- : Supports e-Smart mobile key.
- : Offer a guest in-room detection solution for Front desk to monitor (Through hotel door lock and motion sensor, etc)
- : Simple and easy installation
- : Comfortable courtesy light when removing the guest card from the energy saving unit.
- : Able to insert card with casing (ES200 only)

## TECHNICAL DATA

	ES100-00	ES100-01	ES100-02
Description	Energy saving unit with 3rd party room controller	Standalone single relay energy saving unit	Standalone dual relay energy saving unit
Credential	RFID Card, Mobile Key (Optional)	RFID Card, Mobile Key (Optional)	RFID Card, Mobile Key (Optional)
Guest/Staff keycard	Depending on 3rd party Room controller, it prevents hotel staff from using certain electrical equipment in the room (air conditioning, TV, phone etc.) while cleaning the rooms.		It prevents hotel staff from using certain electrical equipment in the room (air conditioning, TV, phone etc.) while cleaning the rooms.
Input Power	12V DC	110/220 Vac. Tolerance 10 %.	110/220 Vac. Tolerance 10 %.
Consumption:	Max. of 150 mA.	Nominal of 10 mA. Max. of 20 mA.	Nominal of 10 mA. Max. of 20 mA.
Frequency:		50 - 60 Hz	50 - 60 Hz
Number of relay / Max load :		1 relay / Normal load: 25A, Inductive load: 15A	2 relays. One according to the power supply and other potential free / Normal load: 10A, Inductive load: 7A
Dimension (mm) (inch)	Height 110.60 • Width 85.60 • Depth 21	Height 110.60 • Width 85.60 • Depth 21	Height 110.60 • Width 85.60 • Depth 21
	Height 4.35 • Width 3.37 • Depth 0.82	Height 4.35 • Width 3.37 • Depth 0.82	Height 4.35 • Width 3.37 • Depth 0.82
Case Material	UL 94 V-0.	UL 94 V-0.	UL 94 V-0.
ECU Communication (Optional)	1. Lock to 3rd party Controller RS485/Zigbee/WiFi	1. Lock to ECU Zigbee 2.4GHz IEEE 802.15.4 Compliant RF Transceiver	1. Lock to ECU Zigbee 2.4GHz IEEE 802.15.4 Compliant RF Transceiver
	2. Lock to ECU Zigbee 2.4GHz IEEE 802.15.4 Compliant RF Transceiver	2. Gateway to ECU Zigbee/WiFi/RS485	2. Gateway to ECU Zigbee/WiFi/RS485
MUR/DND Function (Optional)	Available	Available	Available

ES200 series has the same spec as ES100 series, and the differences of the two series are the number of card slot (ES100 series has single card slot, ES200 series has dual card slot) and the dimension.

### • Dimensions

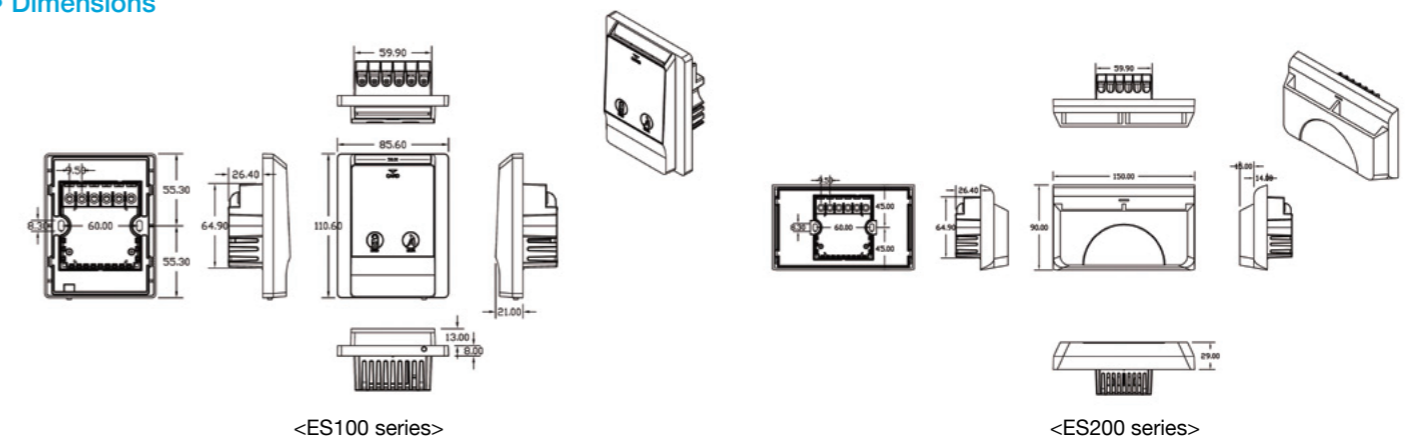

### • Wiring Diagram

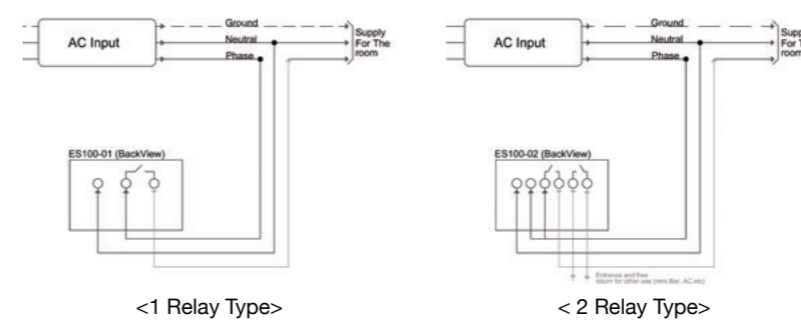

## Portfolio of e-Smart Hotel Lock

HP100-01/02/03



HP200/HP200N-01/02/03



HP200E/HP200EN-01/02/03



HP400/HP400N-02/03



HP400-01



HP500-02/03



### • Mortise Options



01-ANSI(Top)

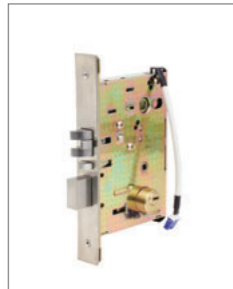

02-ANSI(Bottom)



03-EURO #6

## Accessories



Elevator Controller & Reader



Gateway (AP300)



RFID Reader (DE-620)



Wall Reader



SL300A Smart Door Lock



Energy Saving Unit



Locker Lock ([www.esmartlock.com](http://www.esmartlock.com))



System Card Set



Guest Card



ES100 Safe

## Applications

SMARTeLOCK provides you the most advanced door locking solutions for various facilities including not only the hospitality, but also many other applications such as leisure & fitness, work space, education and rental. Experience our innovative wireless online & mobile access technology and become a part of our global partners.



Hospitality



Leisure & Fitness



Smart Office



Rental



Education



Healthcare



Government



Pro Sports

SMARTeLOCK



## e-Smart

Seamless Unlock Innovation

Hospitality Contactless check-in solutions with IoT & wireless online technology



**SMARTeLOCK Co., Ltd.**

Address : B-403, 215 Galmachi-ro, Jungwon-gu, Seongnam-si, Gyeonggi-do, Rep. of Korea

Tel : +82 31-778-6474 / Fax : +82 31-743-7276

E-mail : [passtech@esmartlock.com](mailto:passtech@esmartlock.com)

Website : [www.smartelock.com](http://www.smartelock.com) (Hotel Lock Solutions)

[www.esmartlock.com](http://www.esmartlock.com) (Locker Lock Solutions)