

# Hospitality Contactless Check-in Solutions

*by e-Smart Mobile Key & Smart Code*



**SMART**  
**eLOCK**



# Seamless Unlock Innovation

Contactless check-in solutions with IoT & wireless online technology



## Professionality

Smartelock’s development team has developers with more than 20 years of relevant experience, and we strive to provide the best service by developing various needs and convenience of the end-users on a daily basis. Besides, we have our own overseas sales force to respond to customers’ needs in real-time.

## Advanced Technology

Applying World’s first 13.56MHz RFID card, Mobile Access, and wireless online locker lock system development know-how to the hotel lock system, we provide more secure, stable, and qualified real-time lock control and monitoring hotel lock system.

## Competitive Price

We offer a competitive price and better or similar functions compared to other well-known and leading hotel door locks. Also our locks don’t require any additional installation fee as they are wireless online locks and thus they don’t need any wiring work, unlike other wired online locks.

## Customizing Service

We provide prompt customer service and solutions to the customer’s any personal requests. As we own our R&D center, we proudly offer solutions straight away to the customer to review and apply.

## Full 3rd party integration

All our Smartelock hotel locks support 3rd party integration and compatible with them, such as PMS, GRMS, Room Intercom, and so on.

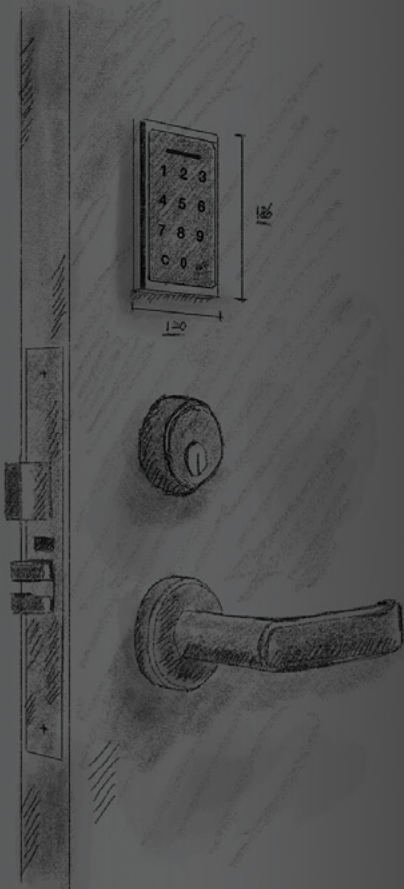

## Why SMARTeLOCK ?

- 01
  - RFID/Mobile technology R&D capability
  - Rich and long experienced engineers
  - Real-time customizing
- 02
  - Own R&D (S/W, H/W)
  - Own factory and quality assurance
  - On-time delivery
- 03
  - Proven quality in global market
  - Reliable reference
  - Competitive price

# Seamless Unlock Innovation

Hospitality Contactless check-in solutions with IoT & wireless online technology

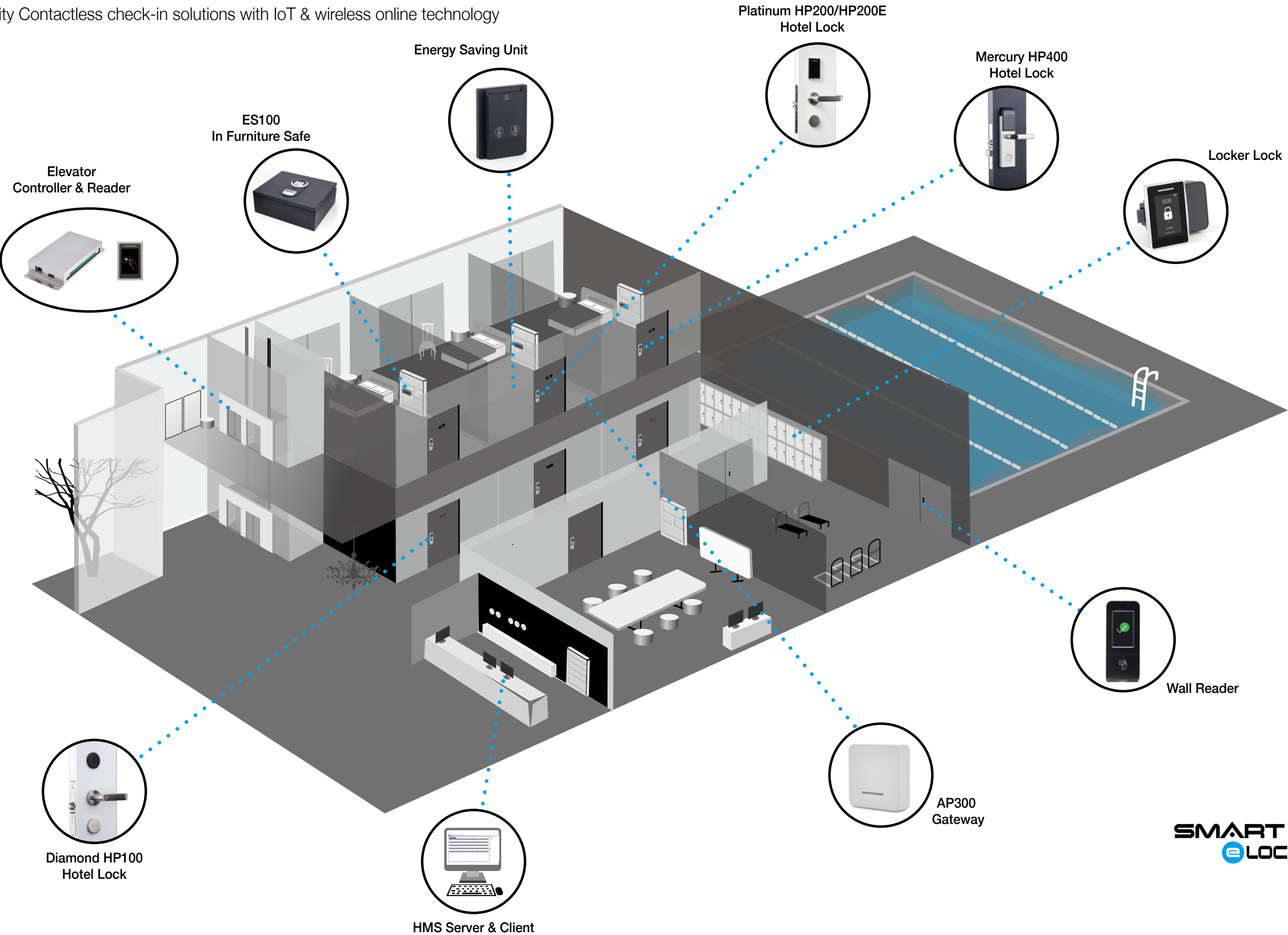



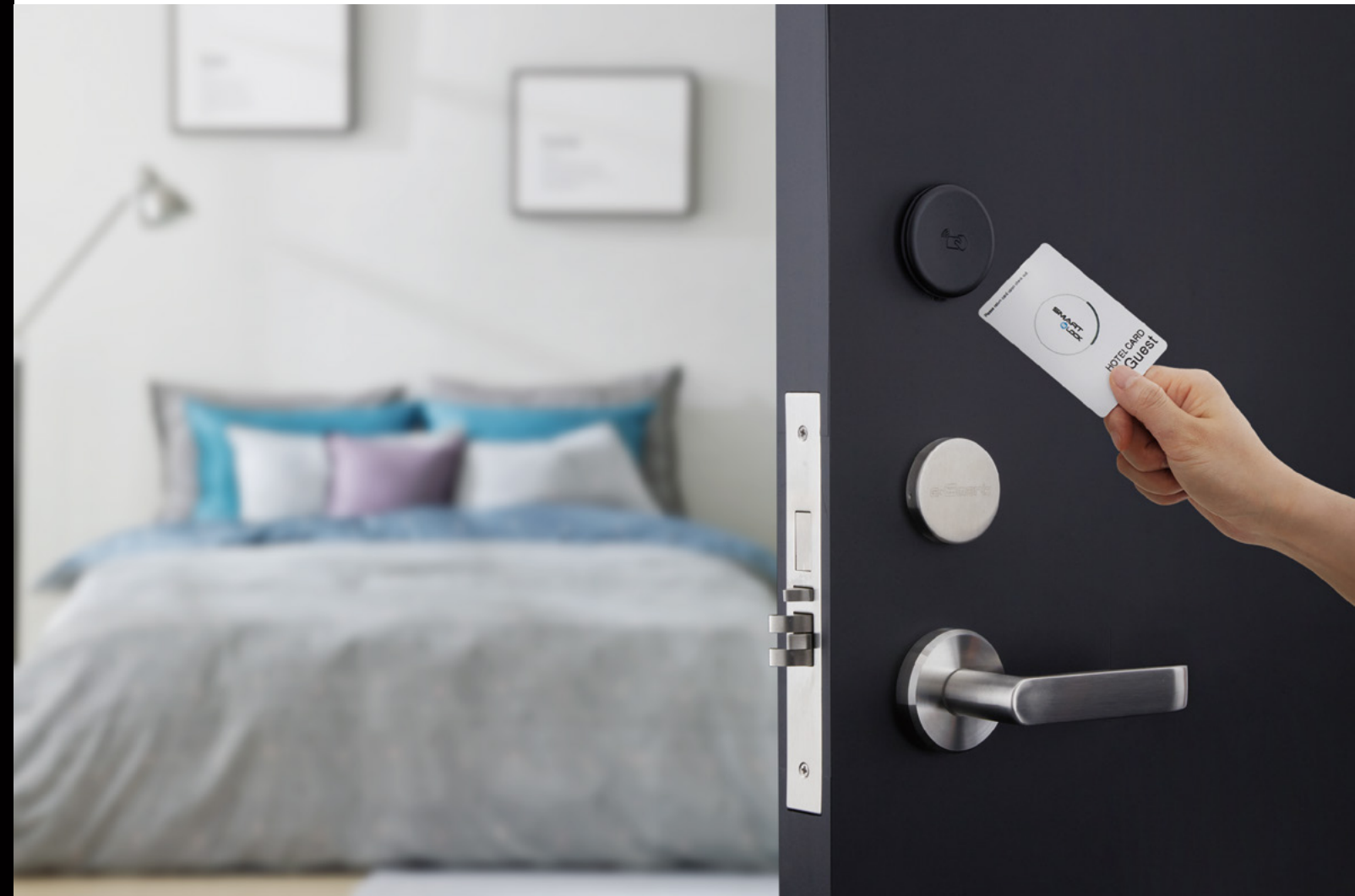

## Feature

- Support RFID technology: Mifare classic & Desfire, ISO14443 Type A/B, ISO15693
- Support mobile key (BLE 4.0 or higher)
- BLE/ZIGBEE Unique security key by AES128 security algorithm
- Audit trail up to 2,000 events by RFID card or Smartphone
- Mortise standard: ANSI/EURO
- Support Dead bolt
- Provide Intrusion alarm
- Door Open/Close detection Sensor (Optional)
- Provide Ajar alarm
- Support Panic release: Deadbolt and latch are automatically retracted by inside handle for easy regress in emergency situations
- Mechanical override: Hidden cylinder key inside
- Lock Management by mobile app (Master key/FW update/Audit Trail/Battery Status check/etc.)
- Power Source : 1) Battery life: 18months and more (AA x 4)  
2) Wired Power (12V) - Optional
- Certifications: CE, FCC, KC approved



Diamond HP100

• Color options

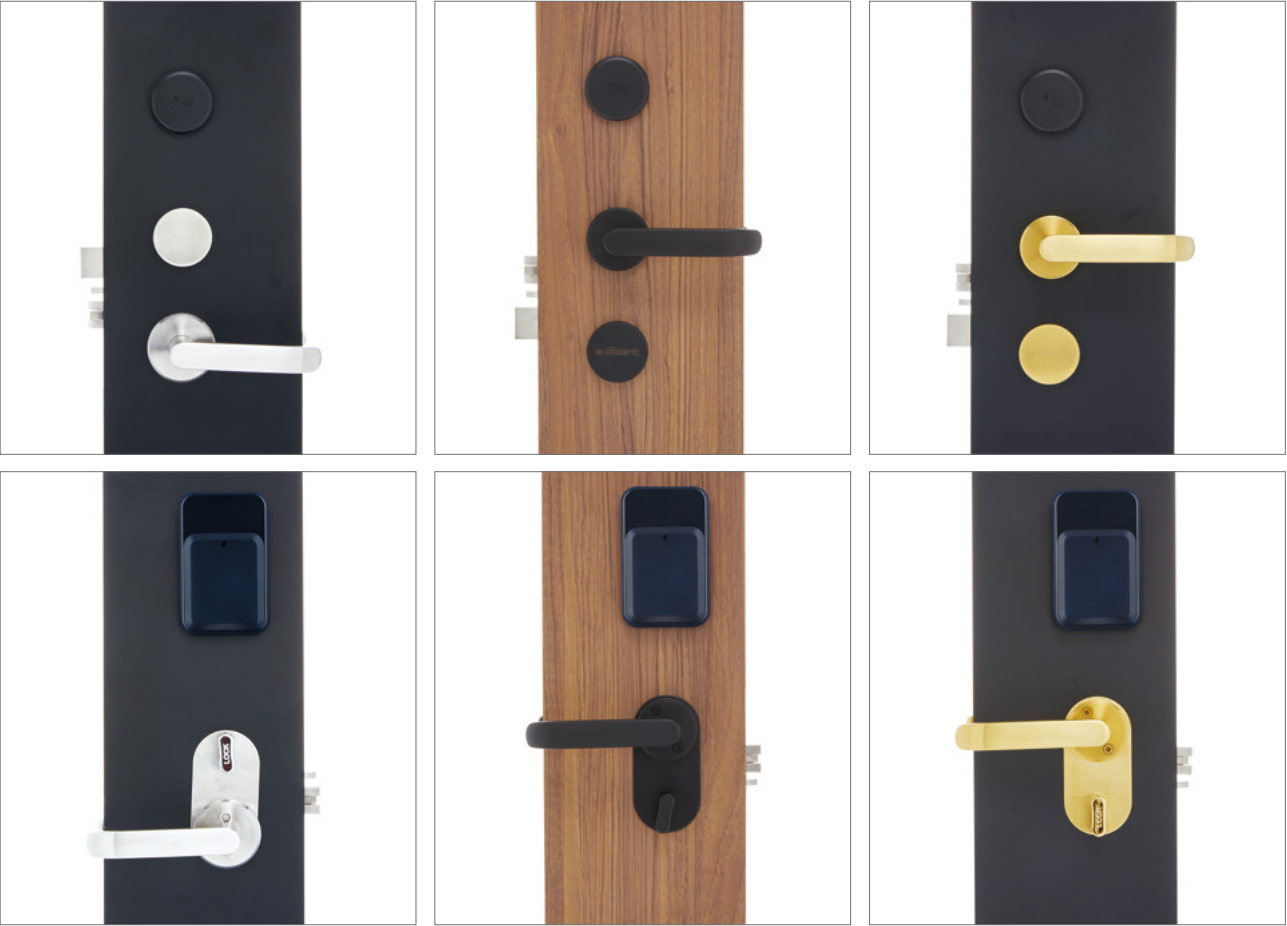

< SILVER >

< BLACK >

< GOLD >

• Mortise Options

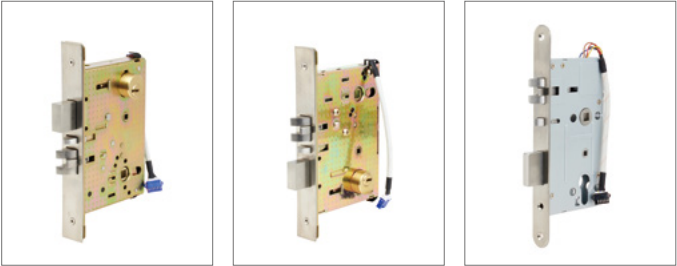

ANSI(Top)

ANSI(Bottom)

EURO #6

• Handle Options



L1 type

L2 type

7 size type

J type

Z type

P type

T type

• Dimensions

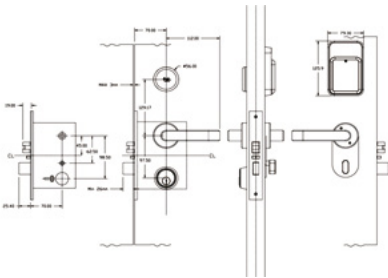

• Installation

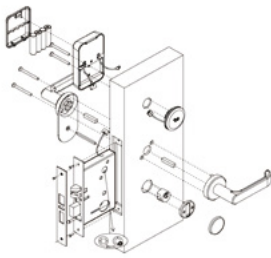



## Feature

- Support RFID technology: Mifare classic & Desfire, ISO14443 Type A/B, ISO15693
- Support mobile key (BLE 4.0 or higher)
- BLE/ZIGBEE Unique security key by AES128 security algorithm
- Support PIN code(Smart code)  
Use 10~12 pin code which is provided with HashCode algorithm from the client software or cloud server
- Audit trail up to 2,000 events by RFID card or Smartphone
- Mortise standard: ANSI/EURO
- Support Dead bolt
- Provide Intrusion alarm
- Door Open/Close detection Sensor (Optional)
- Provide Ajar alarm
- Support Panic release: Deadbolt and latch are automatically retracted by inside handle for easy regress in emergency situations
- Mechanical override: Hidden cylinder key inside
- Lock Management by mobile app (Master key/FW update/Audit Trail/Battery Status check/etc.)
- Power Source : 1) Battery life: 18months and more (AA x 4)  
2) Wired Power (12V) - Optional
- Certifications: CE, FCC, KC approved



# Platinum HP200

## • Color options



< SILVER >

< BLACK >

< GOLD >

## • Mortise Options

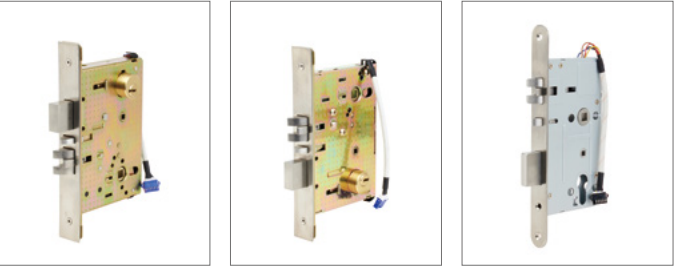

ANSI(Top)

ANSI(Bottom)

EURO #6

## • Handle Options



L1 type

L2 type

7 size type

J type

Z type

P type

T type

## • Dimensions

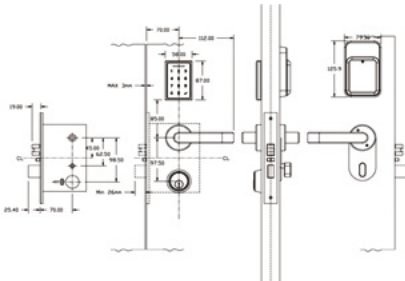

## • Installation

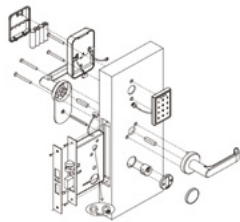

### Convenience of Smart Code for Group of Guests

- 1 Receive smart code (10~12 digits)
- 2 Only for first time, use the 10~12 digits smart code on the lock
- 3 Use only the last 4 digits of the smart code to access the lock

- Suitable for group of guests or multiple customers who are staying in one room
- No Guest card needed – cost save

### Smartcode features:

- ✓ Automatically create the pin code only for the duration of stay.
- ✓ 10~12 digit PIN code by e-mail or SMS
- ✓ Work offline, no network connection needed
- ✓ No contact for check-in or key exchange
- ✓ Bypass front desk for registration





### Feature

- Support RFID technology: Mifare classic & Desfire, ISO14443 Type A/B
- Support mobile key (BLE 4.0)
- Support E-display (DND/MUR/Room Number/etc.,)
- BLE/ZIGBEE Unique security key by AES128 security algorithm
- Audit trail up to 2,000 events by RFID card or Smartphone
- Mortise standard: ANSI/EURO
- Support Dead bolt
- Provide Intrusion alarm
- Door Open/Close detection Sensor (Optional)
- Provide Ajar alarm
- Support Panic release: Deadbolt and latch are automatically retracted by inside handle for easy regress in emergency situations
- Mechanical override: Hidden cylinder key inside
- Lock Management by mobile app (Master key/FW update/Audit Trail/Battery Status check/etc.)
- Power Source : 1) Battery life: 18months and more (AA x 4)  
2) Wired Power (12V) - Optional
- Certifications: CE, FCC, KC approved



# Platinum HP200E

## • Color options



< SILVER >

< BLACK >

< GOLD >

## • Mortise Options

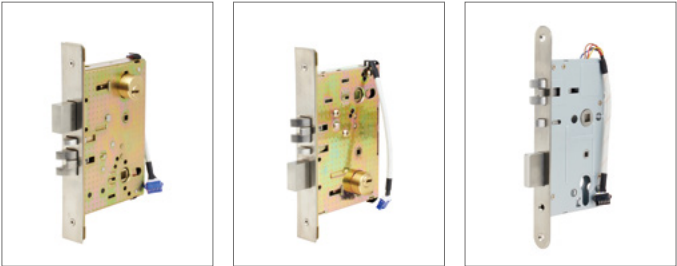

ANSI(Top)

ANSI(Bottom)

EURO #6

## • Handle Options



L1 type

L2 type

7 size type

J type

Z type

P type

T type

## • Dimensions

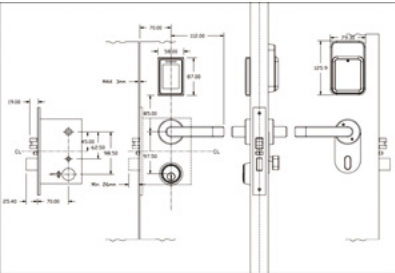

## • Installation

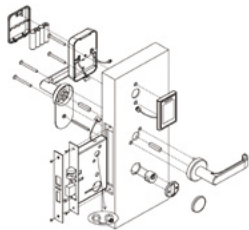

### e-Display Option

- RFID Tag display
- MUR/DND
- Battery Status
- Customized image available.





## Feature

- Support RFID technology: Mifare classic & Desfire, ISO14443 Type A/B, ISO15693
- Support mobile key (BLE 4.0 or higher)
- BLE/ZIGBEE Unique security key by AES128 security algorithm
- Support PIN code(Smart code) Use 10~12 pin code which is provided with HashCode algorithm from the client software or cloud server
- Audit trail up to 2,000 events by RFID card or Smartphone
- Mortise standard: ANSI/EURO
- Support Dead bolt
- Provide Intrusion alarm
- Door Open/Close detection Sensor (Optional)
- Provide Ajar alarm
- Support Panic release: Deadbolt and latch are automatically retracted by inside handle for easy regress in emergency situations
- Mechanical override: Hidden cylinder key inside
- Lock Management by mobile app (Master key/FW update/Audit Trail/Battery Status check/etc.)
- Power Source : 1) Battery life: 18months and more (AA x 4)  
2) Wired Power (12V) - Optional
- Certifications: CE, FCC, KC approved



## Mercury HP400-02/03

- **Color options**

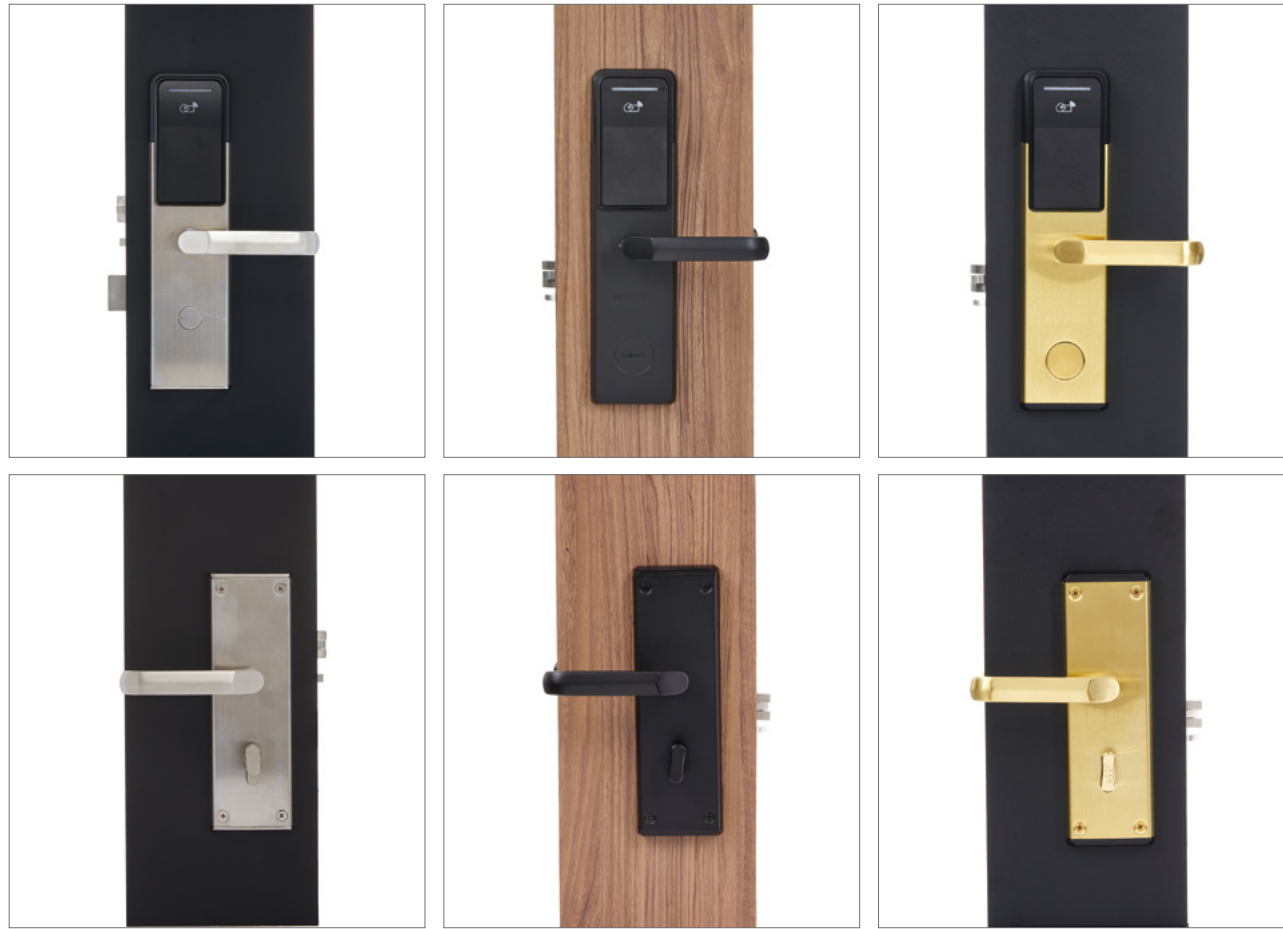

< SILVER >

< BLACK >

< GOLD >

- Mortise Options

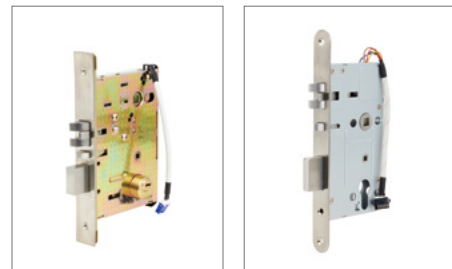

02-ANSI(Bottom)

03-EURO #6

- Handle Options



L type

C type

7 size type

J type

Z type

P type

T type

- Dimensions

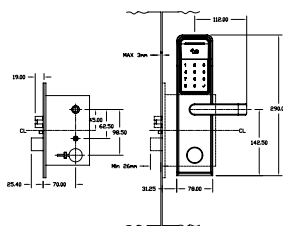

- Installation

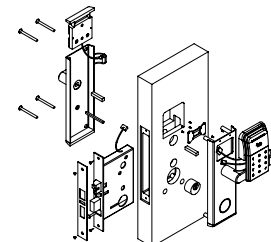





Mercury HP400N-01

• Color options



< SILVER >

< BLACK >

< GOLD >

• Mortise Options



ANSI(Top)

• Handle Options



L type

C type

7 size type

J type

Z type

P type

T type

• Dimensions

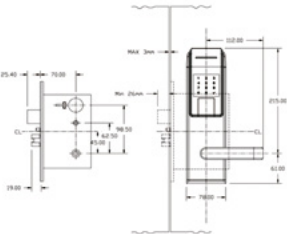

• Installation

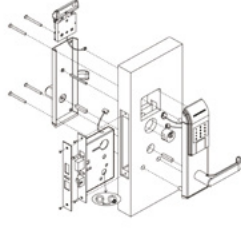

Mercury HP400N-02/03

• Color options

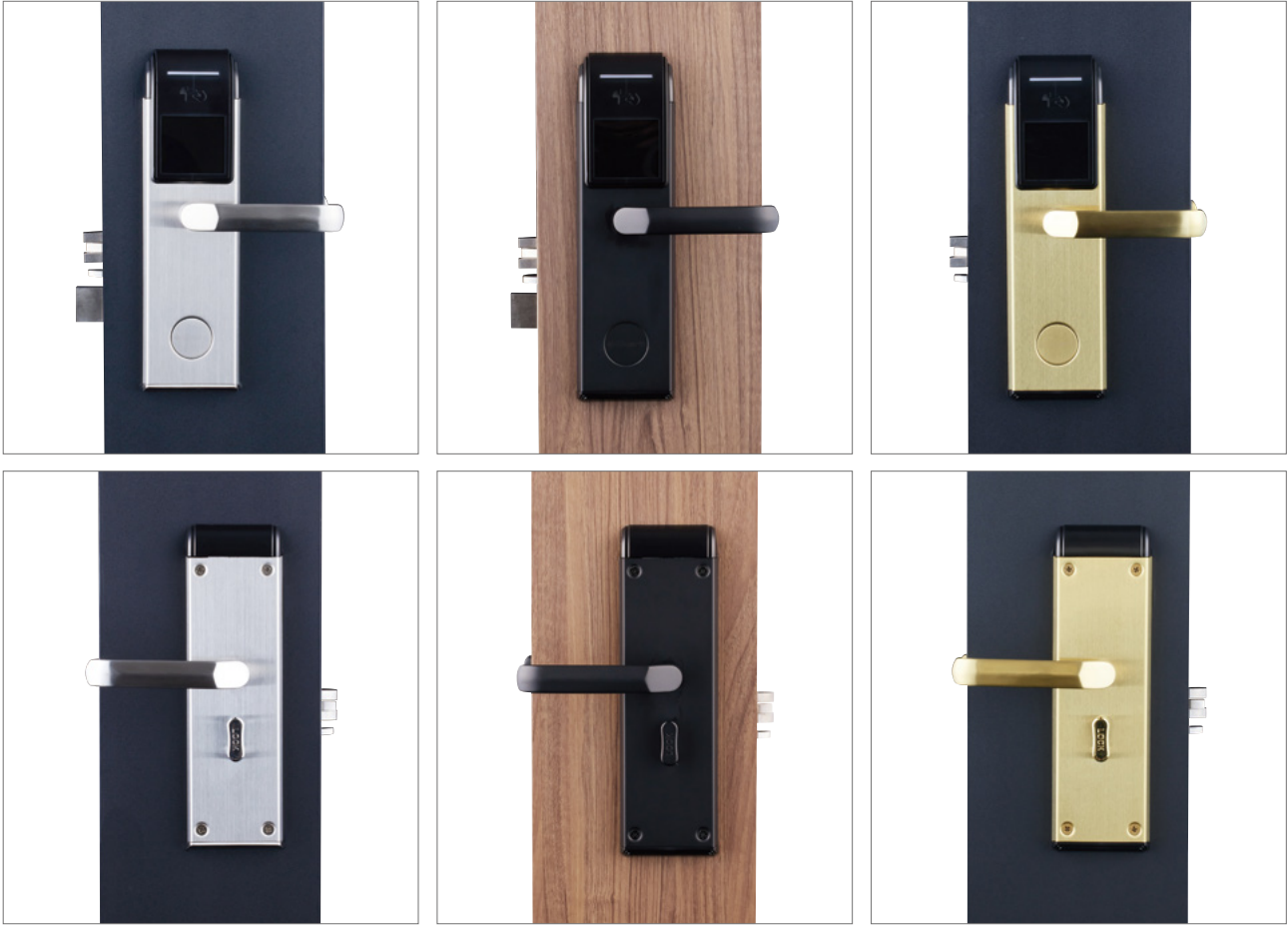

< SILVER >

< BLACK >

< GOLD >

• Mortise Options

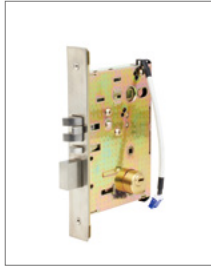

ANSI(Bottom)



EURO #6

• Handle Options



L type

C type

7 size type

J type

Z type

P type

T type

• Dimensions

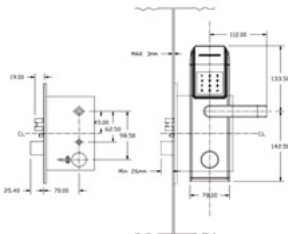

• Installation

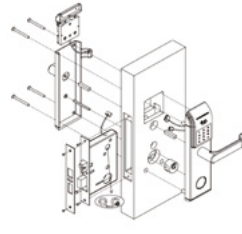



## Feature

- Support RFID technology: Mifare classic & Desfire, ISO14443 Type A/B, ISO15693
- Support mobile key (BLE 4.0 or higher)
- BLE/ZIGBEE Unique security key by AES128 security algorithm
- Support PIN code(Smart code) Use 10~12 pin code which is provided with HashCode algorithm from the client software or cloud server
- Audit trail up to 2,000 events by RFID card or Smartphone
- Mortise standard: ANSI/EURO
- Support Dead bolt
- Provide Intrusion alarm
- Door Open/Close detection Sensor (Optional)
- Provide Ajar alarm
- Support Panic release: Deadbolt and latch are automatically retracted by inside handle for easy regress in emergency situations
- Mechanical override: Hidden cylinder key inside
- Lock Management by mobile app (Master key/FW update/Audit Trail/Battery Status check/etc.)
- Power Source : 1) Battery life: 18months and more (AA x 4)  
2) Wired Power (12V) - Optional
- Certifications: CE, FCC, KC approved



## Mercury HP500-02/03

- **Color options**

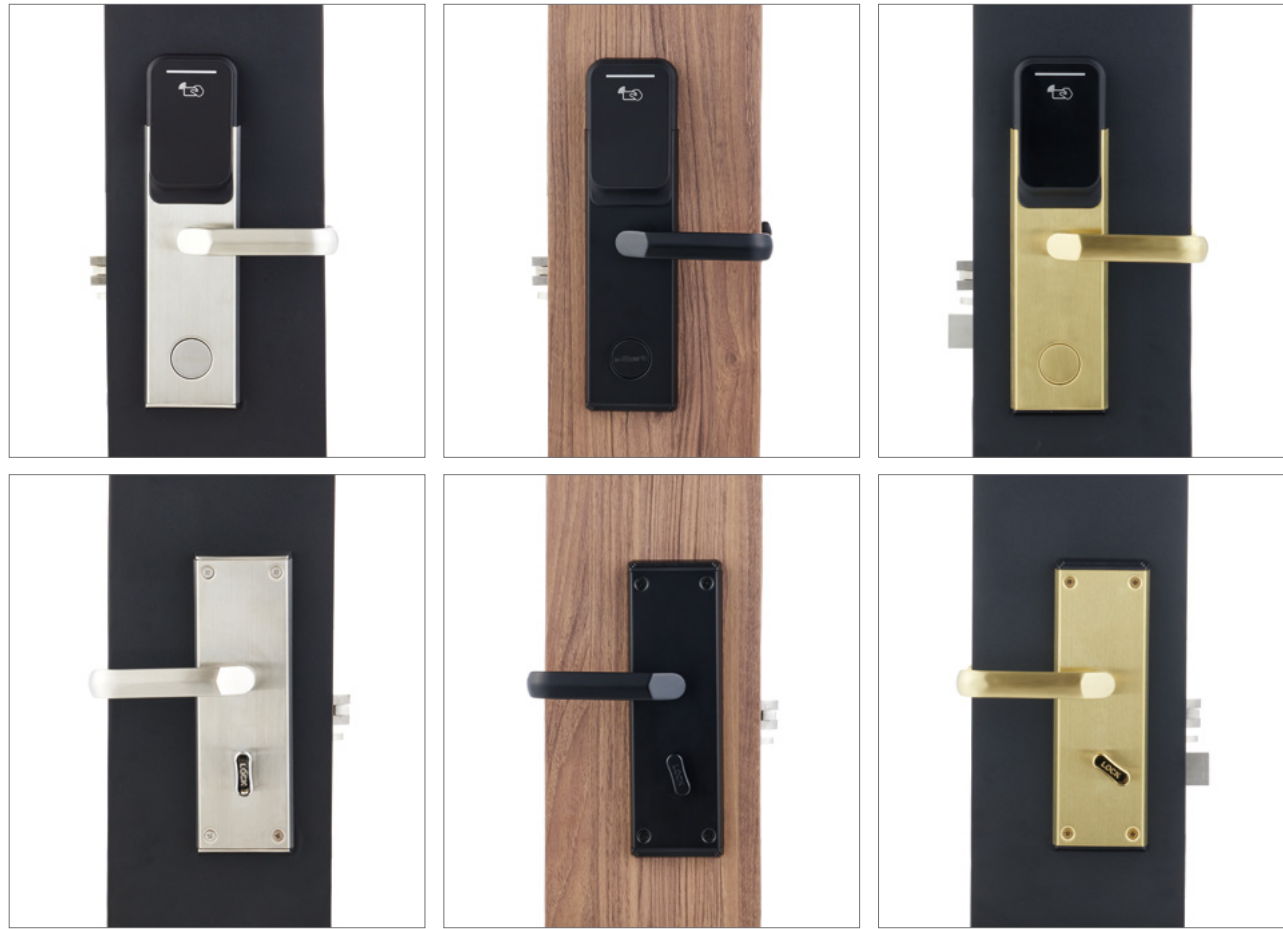

< SILVER >

< BLACK >

< GOLD >

- Mortise Options

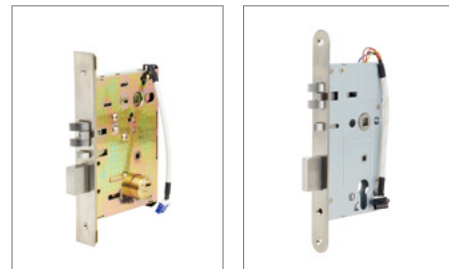

02-ANSI(Bottom)

03-EURO #6

- Handle Options



L type

C type

7 size type

J type

Z type

P type

T type

- Dimensions

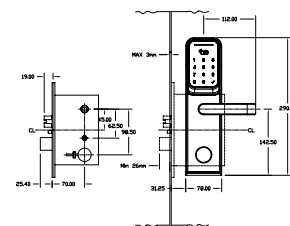

- Installation

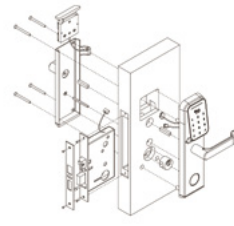

# Management Software

## ▶ Management Software for Distributor

### · e-Smart Cloud Server

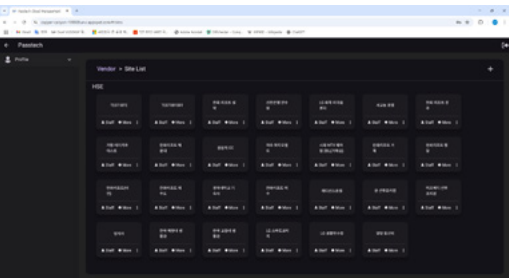

- Manage Vendor(distributor) accounts
- Manage End-client's site account for Admin mobile use (Distributor)
- Generate Mobile key & Smartcode

### · HLKS / On-premise Lock Management Software

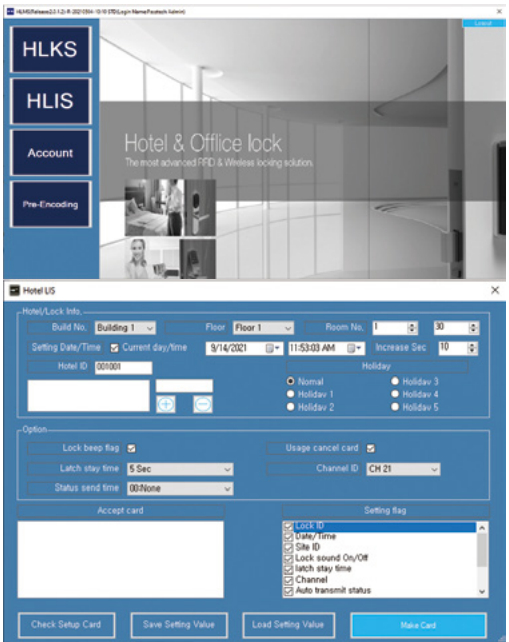

- Generate security key card for customers
- Generate system cards
- Issue Setup Card
- Set lock operation mode
- Program various operation parameters
- Make blank cards

### · e-Smart Cloud HLIS / Cloud based Lock Management Software



- User Authentication / Site account info update from Cloud server
- Generate security key card for customers
- Generate system cards
- Issue Setup Card and set lock operation mode
- Make blank cards

## ▶ Management Software for End-customer

### · e-Smart HMS software

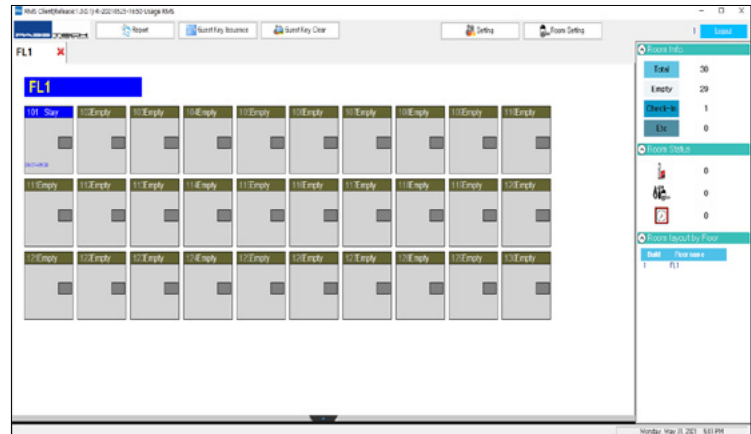

- Guest card issuance
- Staff card issuance (Emergency card, Master card, Maid card, Engineer card etc.)
- Smartcode & Mobile key issuance (i.e. send to guest's phone number or email)
- Auto check-in & Check-out
- Wireless online monitoring function
  - Alarming – low battery, forced open(Intrusion)
  - Real time door open/close status
- Online audit trail (unlimited) and offline audit trail (2000 events)
- Provides various type of management reports
- Manage Access control of common doors - gates, fitness, pool, staff facilities etc.
- Remote Online stay extension without visiting reception
- Remote Online room change without visiting reception
- Online card blacklist function
- Broadcasting command function – all doors open, closed



# Technology & Solutions

## MOBILE ACCESS SOLUTIONS

### Mobile App Key

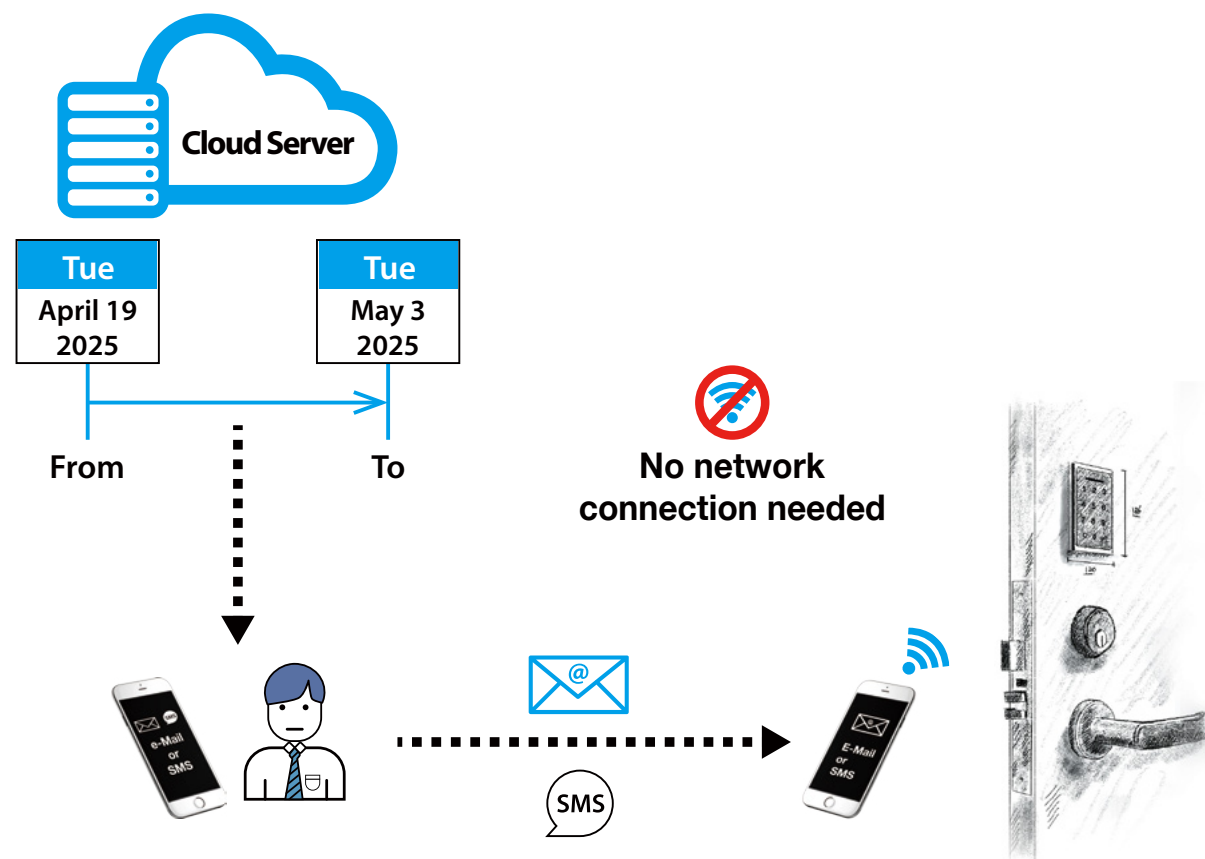

- ✓ No network connection needed
- ✓ Encrypted mobile key by mobile app (Mobile app needed)
  - Over 2~3 seconds for access authentication
- ✓ Bypass front desk for registration
- ✓ No risk of losing keys or cards
- ✓ No contact for check-in or key exchange
- ✓ No guest card needed – cost save

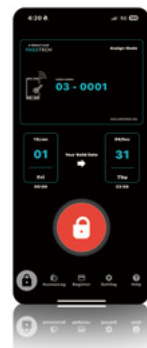

Experience convenient access to your property by Mobile key generated via Cloud anywhere in the world



### Mobile Web Key

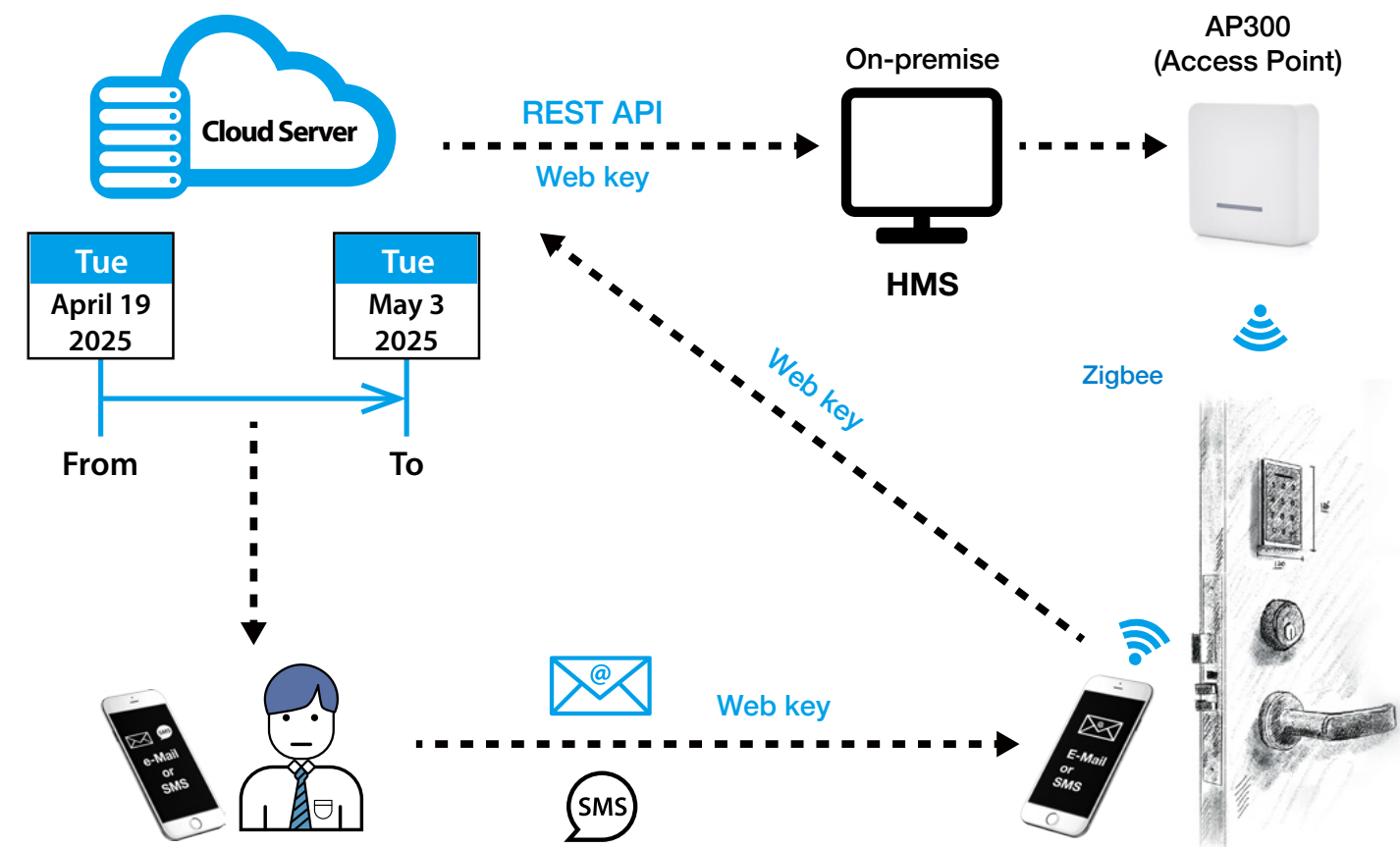

- ✓ Real time online mobile access by smartphone,
  - No mobile app needed – 1~2 seconds for access authentication
- ✓ Network connection always needed
- ✓ Bypass front desk for registration
- ✓ No risk of losing keys or cards
- ✓ No contact for check-in or key exchange
- ✓ No guest card needed – cost save

## PIN CODE SOLUTIONS

### 10 Digit SMARTCODE(Time Sensitive) - Offline

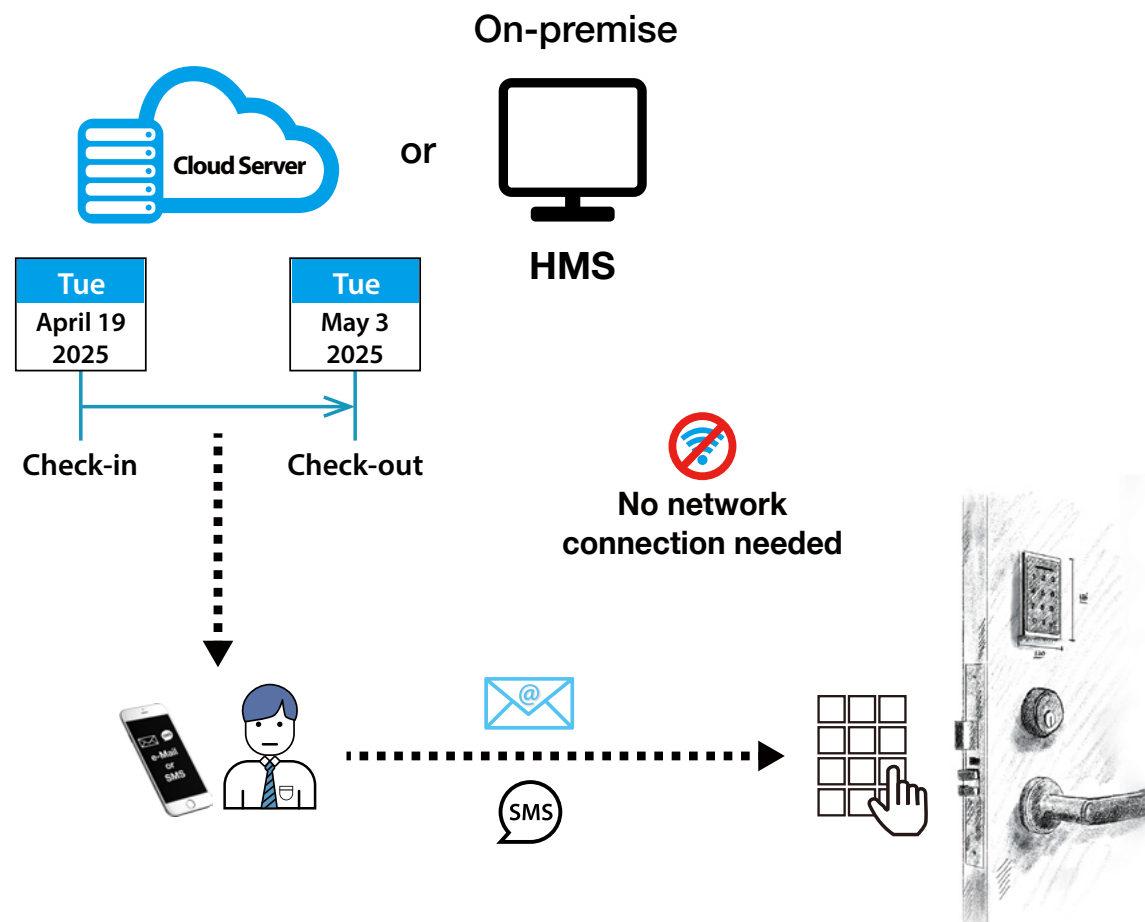

- ✓ Completely Work offline.
- ✓ Receive 10-12 digits SmartCode by SMS.
- ✓ Enter 10-12 digit SmartCode for the first time authentication and use the last 4 digits afterward.
- ✓ Suitable for a group of guests.
- ✓ Bypass front desk for registration.
- ✓ No risk of losing keys or cards.
- ✓ No guest card needed – cost save.

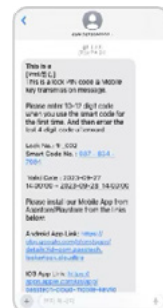

### 4 Digit SMARTCODE(Time Sensitive) - Online

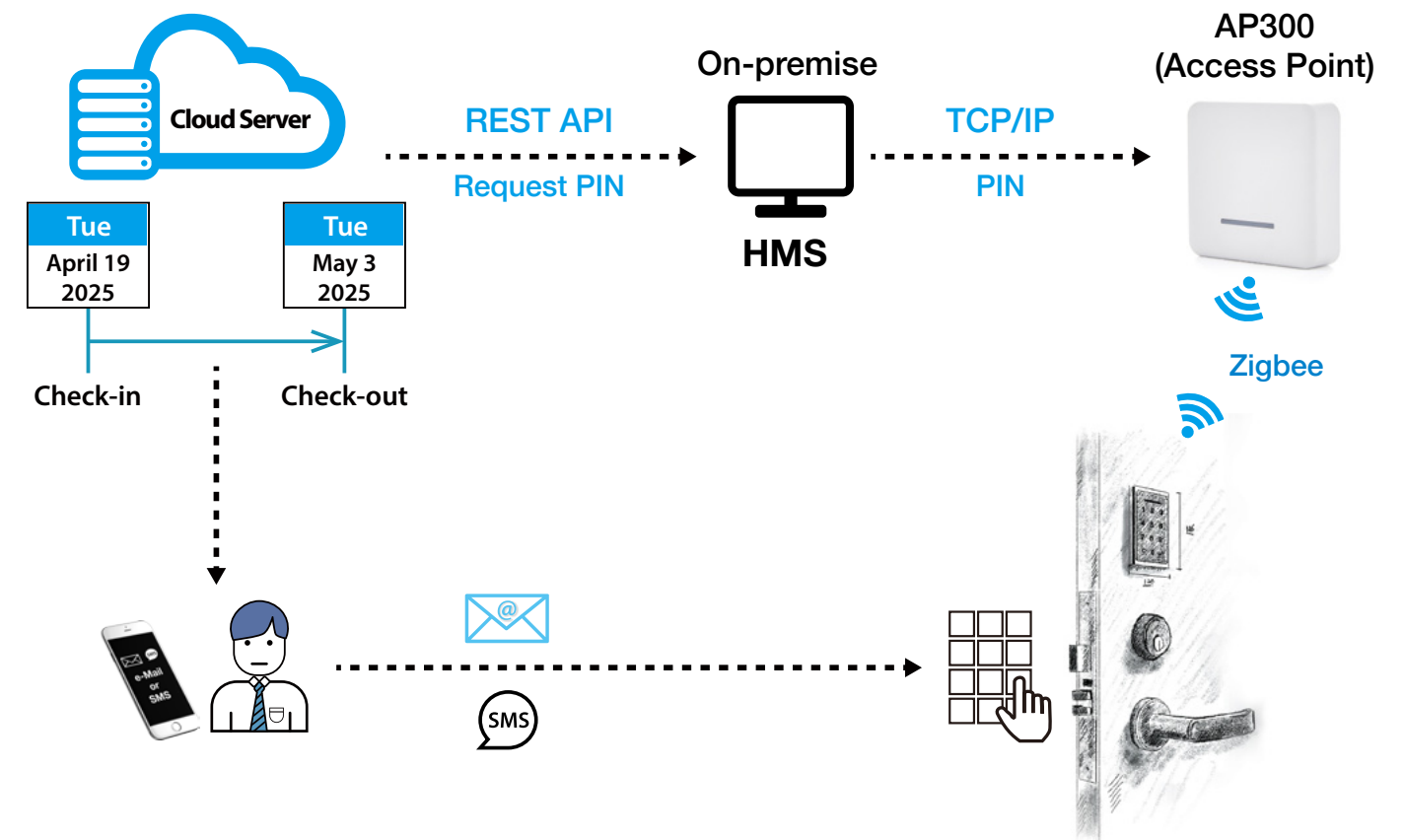

- ✓ Must Work online.
- ✓ Receive 4 digits PIN code by SMS and enter it.
- ✓ Enter 10-12 digits OTP code in case of network failure.
- ✓ Suitable for a group of guests.
- ✓ Bypass front desk for registration.
- ✓ No risk of losing keys or cards.
- ✓ No guest card needed – cost save.



3rd Party Interface

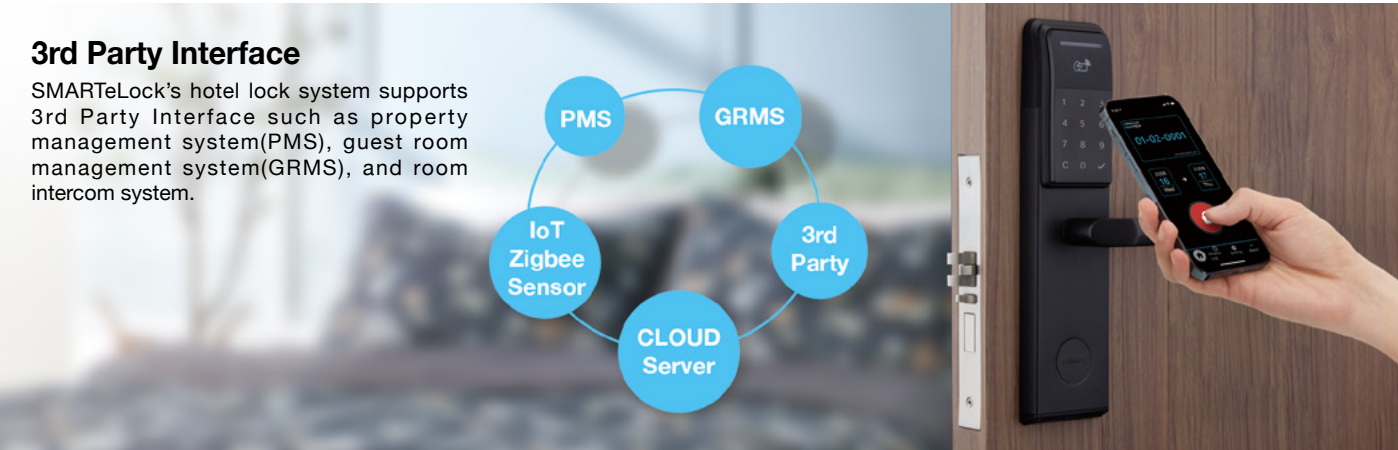

• SMARTeLOCK's hotel lock system supports 3rd Party Interface such as property management system(PMS), guest room management system(GRMS), and room intercom system.

PMS interface

- Support PMS interface that is used in the hotel and provide SMARTeLock's unique total management solution that is for reservation & room management, issuance of guest card, and so on.
- Easily manage your hotel from the front desk using room/staff card issuance program module which is optimized for PMS interface.

GRMS interface

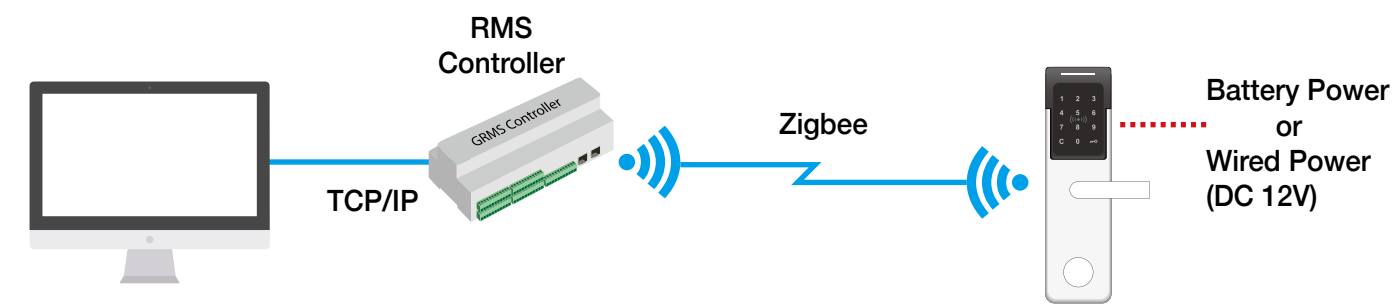

- ※ Provide room/staff card issuance SDK in order to support integration with existing GRMS solution for the total solution.
- ※ If you are using Zigbee stack in your RMS controller or other devices, it can communicate with our door lock with Zigbee.

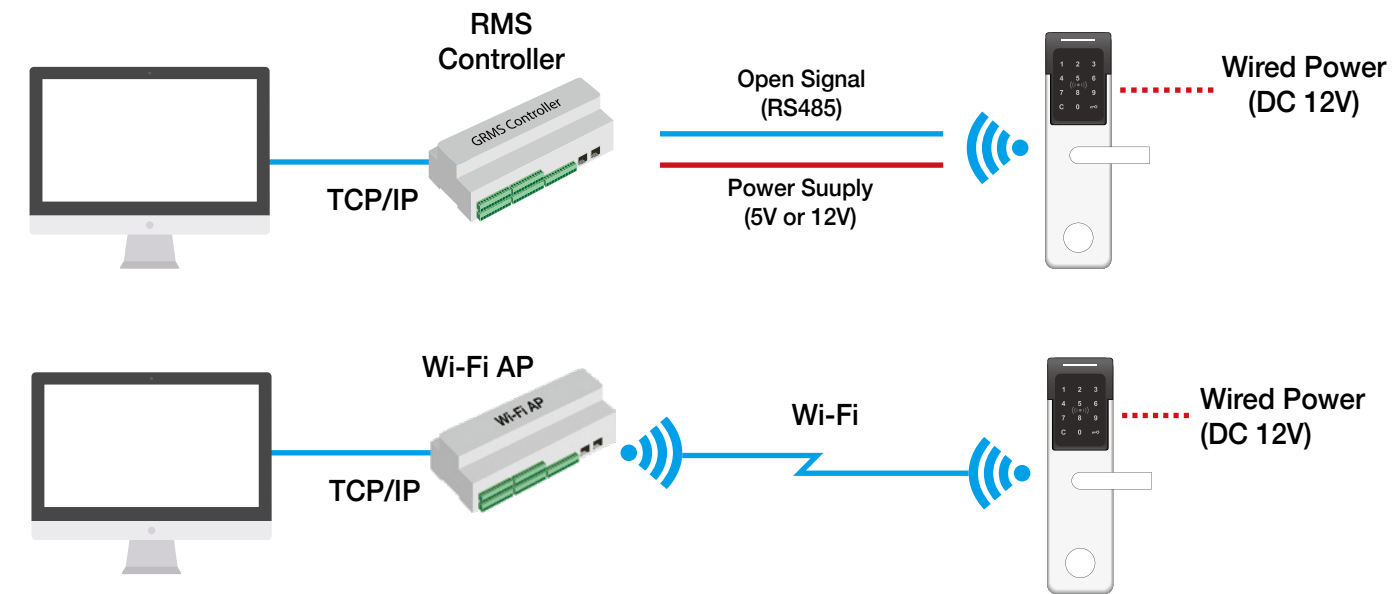

- ※ Door locks can be interfaced with 3rd Party GRMS by using RS485 communication and wired power supply.
- ※ By using commercial Wi-Fi access point, door locks can be interfaced and controlled/monitored wirelessly.

Room intercom interface

- Control it by communicating Door lock with wireless Zigbee module or wired communication module on an Intercom that was installed previously.

Type 1

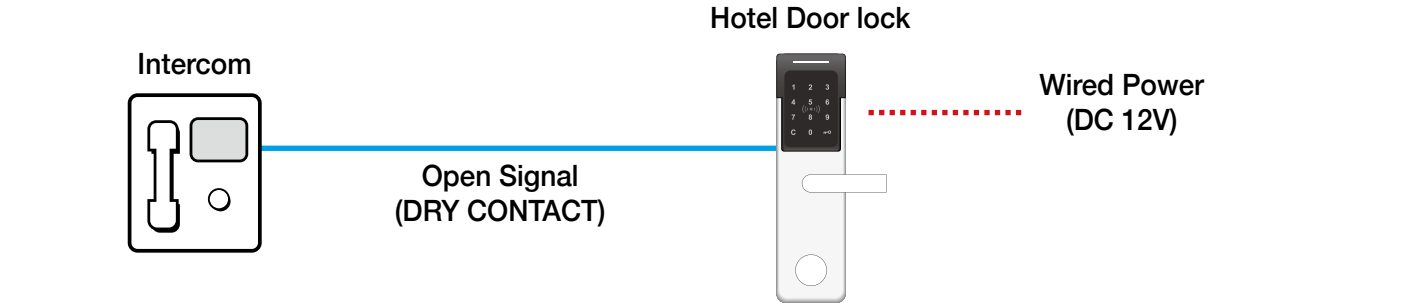

※ Needs Wiring work (1 Line) from Intercom to Hotel door lock.

Type 2

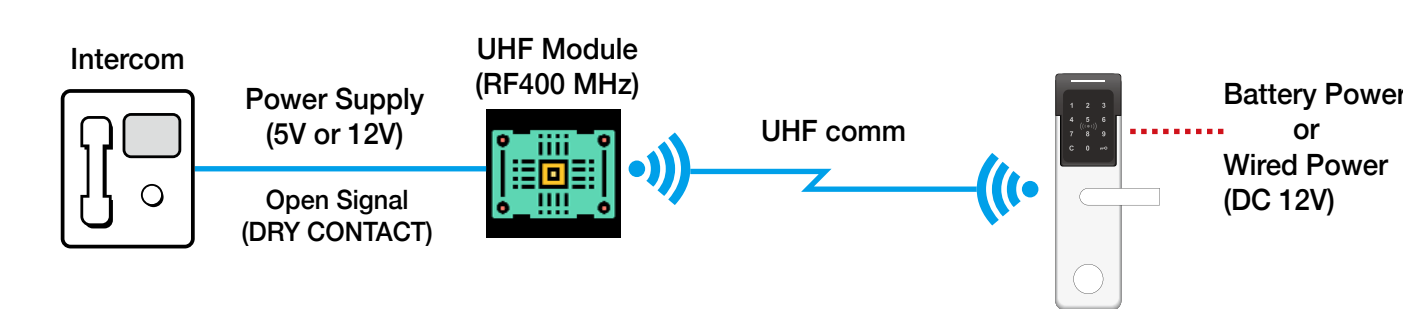

※ Doesn't need Wiring work from Intercom to Hotel door lock.

Software Development Kit (SDK)

- Third-party software companies and end-users are allowed to operate and manage SMARTeLock Hotel door locks by utilizing e-Smart locking solution. API(Application Programming Interface) to control access within their own applications.
- Customer can create card issuance and management system for applications

SDK Packages	Provided by SMARTeLOCK	Developed by Customer
RestFul API	<ul style="list-style-type: none"><li>• RestFul API Protocol Document</li><li>• HMS Server Program</li></ul>	<ul style="list-style-type: none"><li>• Their own server program</li></ul>
Mobile User App For Anroid / iOS	<ul style="list-style-type: none"><li>• SDK for Android/iOS</li><li>• Sample project (program source) for Android/iOS</li></ul>	<ul style="list-style-type: none"><li>• Mobile app for Android/iOS needs to be developed by customer</li></ul>

Wireless Online Solution



There are 4 solutions in Smartelock’s online solutions such as, 1) Wireless online Zigbee communication using SMARTeLock’s AP, 2) Wireless online Zigbee communication using 3rd party GRMS controller, 3) hard-wired RS485 communication using 3rd party GRMS controller, and finally, 4) wireless online communication solution using commercial Wi-Fi AP.

By using these solutions, SMARTeLock offers complete hard-wired / wireless online solution that can be applied to various circumstances.

1) Wireless online Zigbee communication using SMARTeLock’s AP

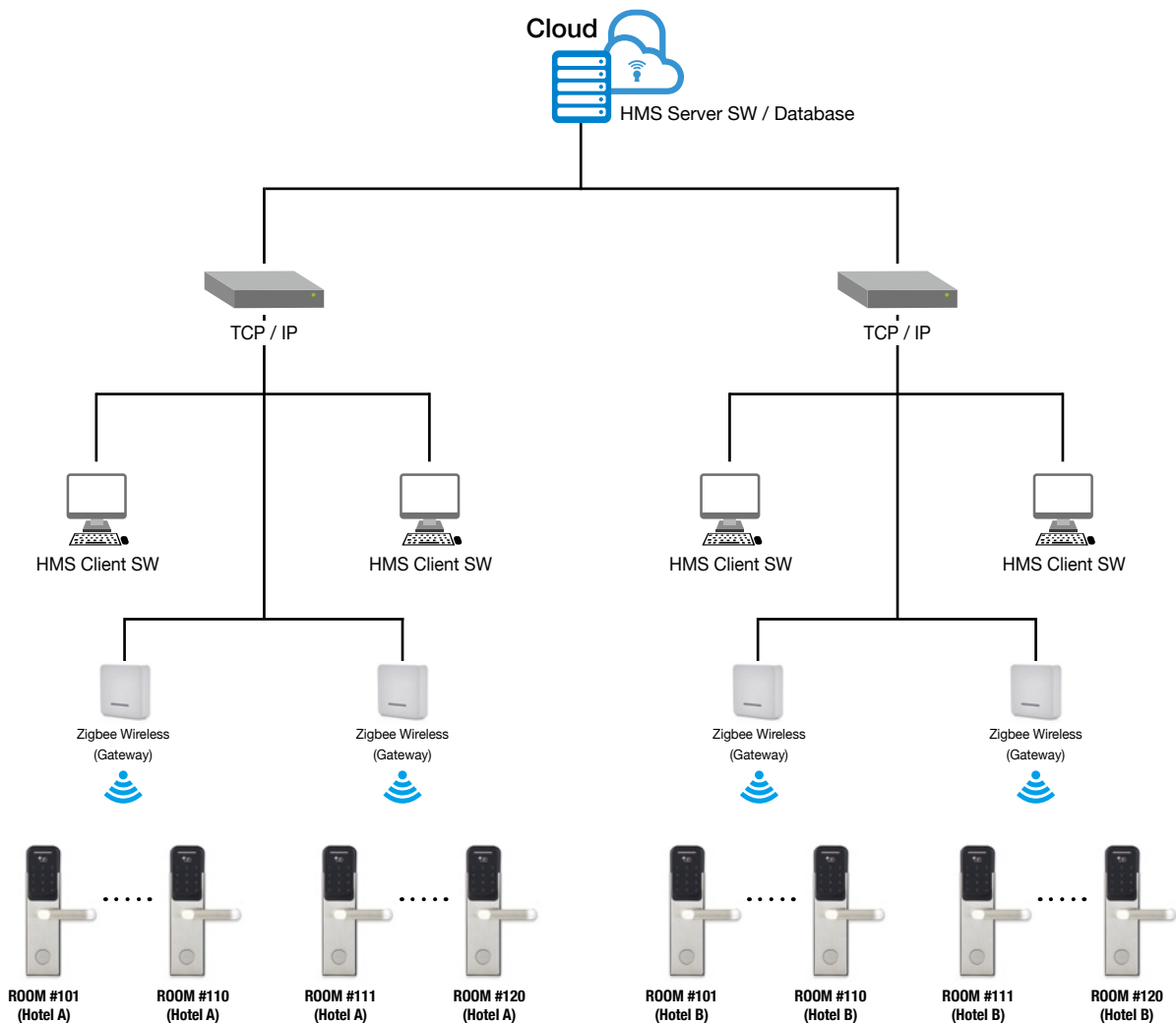

2) Wireless online Zigbee communication using 3rd party GRMS controller

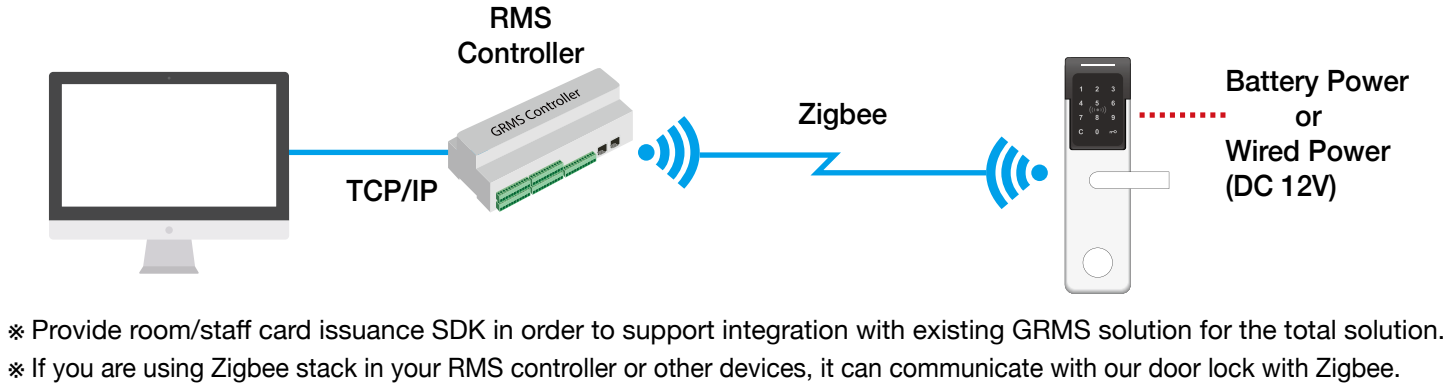

3) Hard-wired RS485 communication using 3rd party GRMS controller

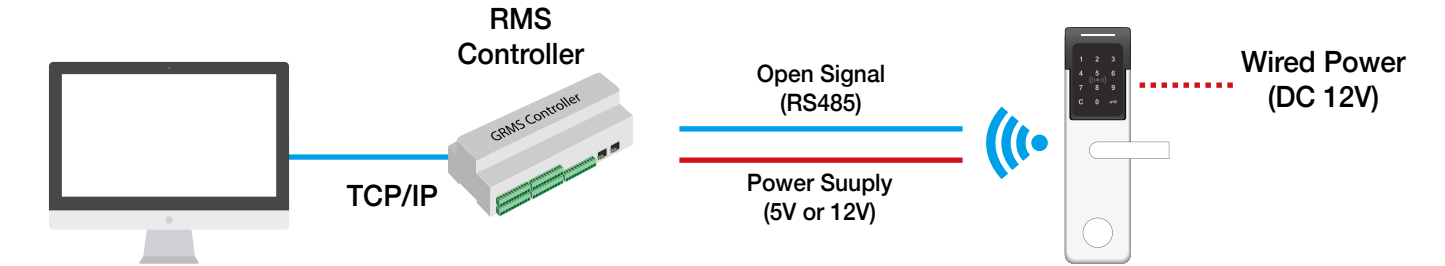

4) Wireless online communication solution using commercial Wi-Fi AP.

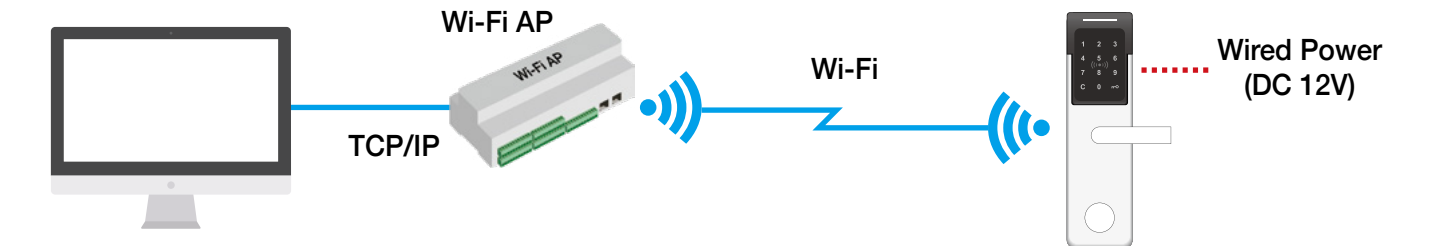

Comparison Table

Features	Standalone Offline	e-Smart HMS Online
Audit Trail	2,000 events (Card) Need to visit the door	Unlimited events(Online) Remote Online Audit Trail
Low battery status	Need to visit the door	Remote Online Low Battery status check
Extension of Stay	Need to visit the reception to extend	Remote Online stay extension without visiting reception
Room Change	Need to visit the reception to change	Remote Online room change without visiting reception
Real time room control & monitoring <ul style="list-style-type: none"><li>Room status Monitoring</li><li>Lock/Card blocking</li><li>Lock opening/closing</li><li>Ajar alarm</li></ul>	Need to visit the door	Remote Online control & monitoring



# System Components & Peripheral Equipments

## Accessories



Elevator Controller & Reader



Gateway (AP300)



RFID Reader (DE-620)



Wall Reader



ER200RM Lock Controller & Reader



Energy Control Unit



Locker Lock (www.esmartlock.com)



System Card Set



Guest Card





ES100 Safe

### Elevator Controller

	ITEM	SPECIFICATION
	Control Floors	16 Floors (Max. 64 Floor extensible)
	Communication to the reader	RS-232
	Indicator	LED
	Power Supply	DC 12V
	Dimension	203.4 x 94.4 x 32.7 (mm)
	Operation temperature	-10°C~ 60°C
	Certificate	CE/FCC/KC

### Elevator Reader

 	ITEM	SPECIFICATION
	Communication to the controller	RS232(Controller)
	Security	AES 128
	User Credentials	RFID CARD (ISO14443 A/B, Mifare, ISO15693), Optional - Mobil key / QR code
	Indicator	Buzzer, LED
	Power Supply	DC 12V
	Dimension	57 x 87 x 11 (mm) - TBD (Flat type)
	Operation temperature	-10°C~ 60°C
	Certificate	CE/FCC/KC

### Gateway (AP300)

	ITEM	SPECIFICATION
	Communication with Server	TCP/IP (standard) 2.4Ghz Wireless(ONLINE LOCK COMM)
	Material	Polycarbonate
	Security	AES128
	Indicator	LED
	Effective range	About 50 meters in open area (without barrier)
	Communication Frequency with locks	2.4GHz IEEE 802.15.4 Compliant RF Transceiver 40-50M (Between Lock and AP)
	Dimension	101.60 x 101.60 x 27.50 (mm) - AP300
	Input Power	DC 12V Adapter, POE (IEEE802.3af)
	Operation temperature	0°C ~ 50°C (Operating), -40°C~85°C(Storage)
	Certificate	CE, FCC

### DE-620 RFID Reader

	ITEM	SPECIFICATION
	RF card protocol	ISO014443 A/B, Mifare, FeliCa, ISO-18092, ISO-15693 /
	PC interface	USB 2.0
	Input power	DC5V, 200mA
	Operation temperature	0°C~ 50°C

### Wall Reader

	ITEM	SPECIFICATION
	RF card protocol	ISO 14443 A/B, Mifare, DESFire, Mobile Key(BLE) - Optional
	Frequency	13.56 MHz
	LCD	4.3"TFT wide(800X480)
	Touch	Resistive touch
	Dimension	163*65*35mm
	Input power	DC9~24V (9V/2A)
	Operation temperature	-10 ~ 60°C

### ER200RM - Lock Controller & Reader

	ITEM	SPECIFICATION
	Power	DC 12V, 1.5A(Adapter)
	Credential	1. RFID Card: ISO014443 A/B, Mifare, Desfire 2. Mobile Access: BLE 4.0 3. Smartcode (Time Sensitive Code)
	Com. Protocol	RS232C Communication

ER200HK - Hook Type Lock

	ITEM	SPECIFICATION
	Power	4 * AA Alkaline batteries
	Credential	1. RFID Card: ISO014443 A/B, Mifare, Desfire 2. Mobile Access: BLE 4.0 3. Smartcode (Time Sensitive Code)
	Functions	Hook Type / Wireless Online / Audit trail (2,000 Events)

ER200DB - Deadbolt Type Lock

	ITEM	SPECIFICATION
	Power	DC 4.5V
	Credential	1. RFID Card: ISO014443 A/B, Mifare, Desfire 2. Mobile Access: BLE 4.0 3. Smartcode (Time Sensitive Code)
	Functions	Deadbolt Type / Wireless Online / Audit trail (2,000 Events)

EC300 - Gate Controller & Reader

	ITEM	SPECIFICATION
	Power	IEEE 802.3af Power over Ethernet (PoE)
	Credential	1. RFID Card: ISO014443 A/B, Mifare, Desfire 2. QR Code
	Com. Protocol	TCP / IP

CL100 - Caravan Lock

	ITEM	SPECIFICATION
	Power	4 * AA Alkaline batteries
	Credential	Mobile Access: BLE 4.0, Smartcode (Time Sensitive Code)
	Functions	Offline / Wireless Online(Optional) / Audit trail (2,000 Events)

Locker Lock(ZP100)

	ITEM	SPECIFICATION
	RF card protocol	ISO014443 A/B, Mifare, FeliCa, ISO-18092, ISO-15693
	Input power	4 * AA Alkaline batteries
	Operation temperature	0°C~ 50°C

System Card Set

	ITEM	SPECIFICATION
	RF card protocol	ISO014443 A/B, Mifare, FeliCa, ISO-18092, ISO-15693
	Operation temperature	0°C~ 50°C

Guest card

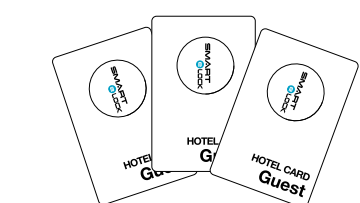
	ITEM	SPECIFICATION
	Dimension	ISO 7816 (85.6x53.98x0.76mm)
	RFID chip	ISO 14443 type A / B :Mifare, Desfire & additional cards on request
	Logo	Customer logo to be printed on request
	Operation temperature	0°C~ 50°C

In Furniture Safes

Model	ES100	ES300
Picture		
External size	150(H) x 410(W) x 350(D) (mm)	200(H) x 400(W) x 300(D) (mm)
Weight	10KG	12KG
Opening Type	Top opening	Front opening
PIN code	4 digits	
RFID credentials	MIFARE Classic & DESFire as default, ISO 14443 Type A	
Mobile access (Optional)	E-Smart Mobile ID, Mobile Sync, Mobile Key	
Emergency opening	Mechanical override key, Master code	
Certification	CE, FCC, KC	
Power Supply	4 x AA Alkaline batteries	
Audit trail	2,000 Events	
Wireless Online	Optional	



**Energy Control Unit**

SmarteLock's Energy control unit(Key holder) solution provides various smart features such as, differentiating card to limit use of in-room electrical devices to save energy and guest in-room detection through communicating various in-room devices for front desk to monitor.

Compatible with e-Smart mobile key, SmarteLock's Energy control unit(Key holder) detects e-Smart mobile key and allows full-feature of energy control unit(Key holder) without use of RFID card.

**Features**

- Save energy when the guests are not in their room.
- Identify the guest card/staff card/dummy card intelligently and control separately.
- Supports e-Smart mobile key.
- Offer a guest in-room detection solution for Front desk to monitor (Through hotel door lock and motion sensor, etc)
- Simple and easy installation
- Comfortable courtesy light when removing the guest card from the energy control unit.
- Easy to insert card with casing (ECU200 only)

SmarteLock's Energy control unit(Key holder) solution provides various smart features such as, differentiating card type to limit use of in-room electrical devices to save energy and guest in-room detection through communicating with various in-room devices for front desk to monitor.

## Features

- : Save energy when the guests are not in their room.
- : Verify the guest card/staff card/dummy card intelligently and control separately.
- : Supports e-Smart mobile key.
- : Offer a guest in-room detection solution for Front desk to monitor (Through hotel door lock and motion sensor, etc)
- : Simple and easy installation
- : Comfortable courtesy light when removing the guest card from the energy control unit.
- : Able to insert card with casing (ECU200 only)

	ECU100-00	ECU100-01	ECU100-02
Description	Energy saving unit with 3rd party room controller	Standalone single relay energy saving unit	Standalone dual relay energy saving unit
Credential	RFID Card, Mobile Key (Optional)	RFID Card, Mobile Key (Optional)	RFID Card, Mobile Key (Optional)
Guest/Staff keycard	Depending on 3rd party Room controller, it prevents hotel staff from using certain electrical equipment in the room (air conditioning, TV, phone etc.) while cleaning the rooms.		It prevents hotel staff from using certain electrical equipment in the room (air conditioning, TV, phone etc.) while cleaning the rooms.
Input Power	12V DC	110/220 Vac. Tolerance 10 %.	110/220 Vac. Tolerance 10 %.
Consumption:	Max. of 150 mA.	Nominal of 10 mA. Max. of 20 mA.	Nominal of 10 mA. Max. of 20 mA.
Frequency:		50 - 60 Hz	50 - 60 Hz
Number of relay / Max load :		1 relay / Normal load: 25A, Inductive load: 15A	2 relays. One according to the power supply and other potential free / Normal load: 10A, Inductive load: 7A
Dimension (mm) (inch)	Height 110.60 • Width 85.60 • Depth 21	Height 110.60 • Width 85.60 • Depth 21	Height 110.60 • Width 85.60 • Depth 21
	Height 4.35 • Width 3.37 • Depth 0.82	Height 4.35 • Width 3.37 • Depth 0.82	Height 4.35 • Width 3.37 • Depth 0.82
Case Material	UL 94 V-0.	UL 94 V-0.	UL 94 V-0.
ECU Communication (Optional)	1. Lock to 3rd party Controller RS485/Zigbee/WiFi	1. Lock to ECU Zigbee 2.4GHz IEEE 802.15.4 Compliant RF Transceiver	1. Lock to ECU Zigbee 2.4GHz IEEE 802.15.4 Compliant RF Transceiver
	2. Lock to ECU Zigbee 2.4GHz IEEE 802.15.4 Compliant RF Transceiver	2. Gateway to ECU Zigbee/WiFi/RS485	2. Gateway to ECU Zigbee/WiFi/RS485
MUR/DND Function (Optional)	Available	Available	Available

- Dimensions

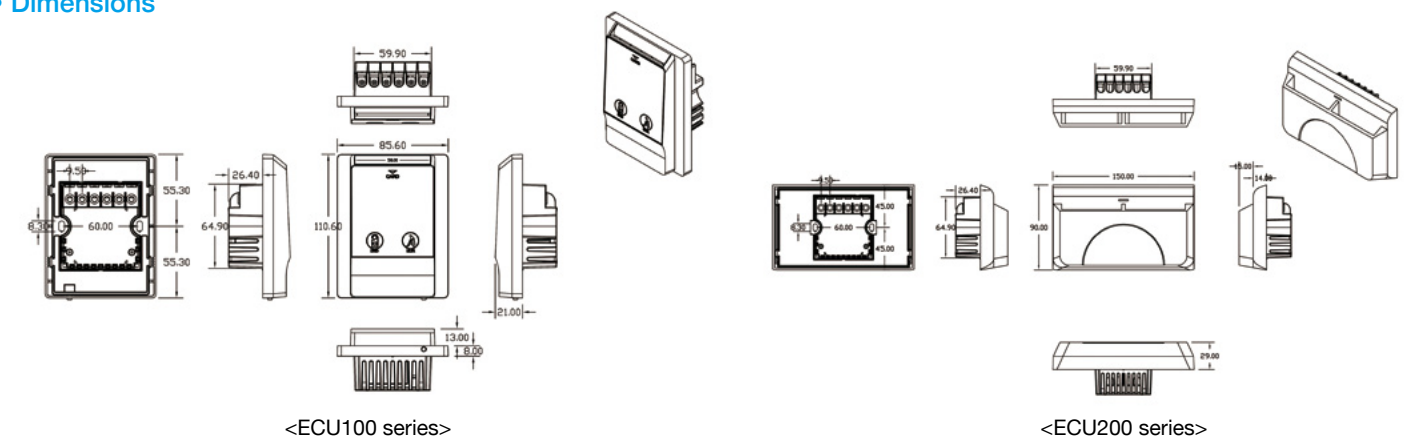

Figure 1 illustrates the backview wiring for two types of relays: <1 Relay Type> and <2 Relay Type>.

The <1 Relay Type> diagram shows an AC Input connected to a single relay switch. The switch is controlled by the Phase line. The Ground and Neutral lines are connected to the supply for the room. The Phase line is connected to the supply for the room.

The <2 Relay Type> diagram shows an AC Input connected to a double relay switch. The switch is controlled by the Phase line. The Ground and Neutral lines are connected to the supply for the room. The Phase line is connected to the supply for the room. The diagram also indicates the Entrance and Exit lines for the relay switch.



# Portfolio of e-Smart Hotel Lock



## Maintenance Tools

System Card Set

- Key Card
- Setup Card
- Maid Card
- Master Card
- Lock Info Combi-Card(80K)
- Audit Trail Combi-Card(80K)

Admin App(Lock Management App)

- Lock Setup
- Lock Info Check
- Audit Trail
- Master Key
- Elevator Setting
- Firmware Update
- Factory Clear

System Card Set

# Applications

SMARTeLOCK provides you the most advanced door locking solutions for various facilities including not only the hospitality, but also many other applications such as leisure & fitness, work space, education and rental. Experience our innovative wireless online & mobile access technology and become a part of our global partners.



Hospitality



Leisure & Fitness



Smart Office



Rental



Education



Healthcare



Goverment



Pro Sports





**e-Smart**

Seamless Unlock Innovation

Hospitality Contactless check-in solutions by e-Smart Mobile Key & Smart Code



**SMARTeLOCK Co., Ltd.**

Address : B-403, 215 Galmachi-ro, Jungwon-gu, Seongnam-si, Gyeonggi-do, Rep. of Korea

Tel : +82 31-778-6474 / Fax : +82 31-743-7276

E-mail : [passtech@esmartlock.com](mailto:passtech@esmartlock.com)

Website : [www.smartelock.com](http://www.smartelock.com) (Hotel Lock Solutions)

[www.esmartlock.com](http://www.esmartlock.com) (Locker Lock Solutions)